

* Preferred Parking Areas.
Do not shoot to the east
towards private residences
at these two locations.

Prairie Dog Colonies - Perkins County Grand River Ranger District

Roads Open For Travel	Bureau of Reclamation
Administrative Boundary	Grand River Coop GA
Streams and Drainages	National Grassland
Prairie Dog Colony - 2021-2022	Private
Black labels next to colony represent acres in 2021-2022	State Lands

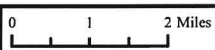
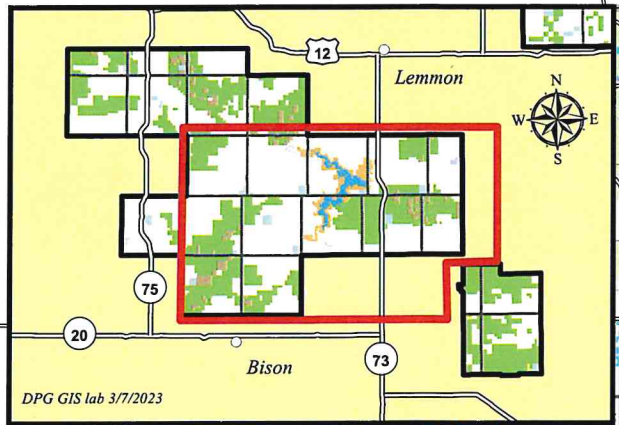

General Prairie Dog Hunting Information

- Season - Open Year Round
- There are no daily or possession limits
- Shooting hours are from sunrise to sunset

For more information regarding prairie dogs on Forest Service land, or for a more detailed map, contact the

Grand River Ranger District
 1005 5th Ave. W
 P.O. Box 390
 Lemmon, SD 57638
 (605) 374-3592

HUNTING LICENSE INFORMATION

- South Dakota Hunting and Trapping Handbook
- www.gfp.sd.gov
- (605) 223-7660

MOTOR VEHICLE TRAVEL

Please refer to the Grand River National Grassland Motor Vehicle Use Map for designated travel routes.
REMEMBER: PACK IT IN, PACK IT OUT

DO NOT SHOOT

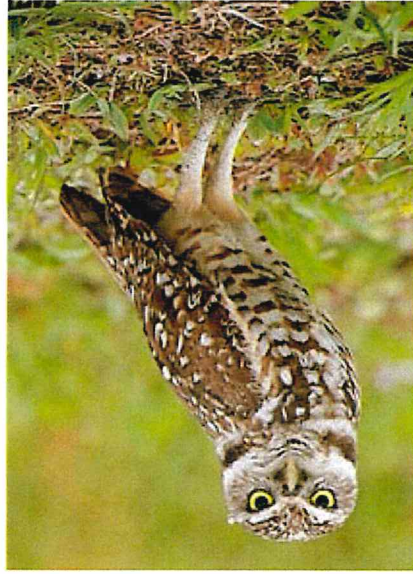

The burrowing owl is a small ground-dwelling bird standing less than one foot tall. It is brown with pale spots. They are often seen standing at the mouth of an abandoned prairie dog burrow, in which they nest and raise an average of 7-9 young. Please be aware of their presence and DO NOT SHOOT them. The burrowing owl population is declining and killing them or any other raptor can result in significant fines.

