



**UNITED STATES DEPARTMENT OF AGRICULTURE
FOREST SERVICE
APACHE-SITGREAVES NATIONAL FORESTS**

PROHIBITIONS:

Pursuant to 16 U.S.C. 551 and 36 CFR 261.50(a) the following act is prohibited within the area of Lakeside Ranger District, Sitgreaves National Forest, in the state of Arizona as described in this Order and depicted on the attached map hereby incorporated into this Order as Exhibit A.

1. Going into or being upon the restricted area which is closed for the protection of the bald eagle. **36 CFR 261.53(a)**

EXEMPTIONS:

Pursuant to 36 CFR 261.50(e) the following persons are exempt from this order:

1. Persons with a permit specifically exempting them from the effect of this Order.
2. Any Federal, State, or local officer, or member of an organized rescue or fire fighting force in the performance of an official duty.

RESTRICTED AREA:

All National Forest System lands, waters, roads, and trails within the boundaries of the restricted area as depicted in Exhibit A, and more particularly described as follows:

Closed to entry from March 1 through August 31; that area beginning at the Show Low Lake eastern shoreline in T9N, R22E, section 10/15 boundary; easterly along section 10/15 boundary for 150 meters; southerly for 425 meters to the power line; southwesterly along power line to the Show Low Lake eastern shoreline; northerly along the shoreline to the T9N, R22E northerly section 10/15 boundary. The area perimeter is defined by signs and includes all land and water within the boundaries as described. The Arizona Game and Fish Department will also place buoys on the lake to prevent boaters from entering the closure area.

PURPOSE:

The purpose of this Order is to protect a bald eagle nesting site in an area of high recreation use, where noise is likely to adversely affect the success of nesting and fledging bald eagles.

IMPLEMENTATION:

1. Prohibitions contained in this Order become effective when signed and will remain in effect until August 31, 2017, unless terminated sooner.
2. These restrictions are in addition to the general prohibitions found at 36 CFR 261, Subpart A.
3. Violation of these prohibitions is punishable by a fine of not more than \$5,000 for individuals and \$10,000 for organizations, imprisonment for not more than six (6) months, or both. [16 USC 551, 18 USC 3559, 3571, and 3581].
4. This Order supersedes, rescinds, and replaces any previous order prohibiting the same acts covered by this Order.

Done at Springerville, Arizona, this 23 day of March, 2017.



M. STEPHEN BEST
Forest Supervisor
Apache-Sitgreaves National Forests

APACHE-SITGREAVES NATIONAL FORESTS

Lakeside Ranger District
Show Low Lake Eagle Closure
Order Number: 01-17-598
Exhibit Number: A

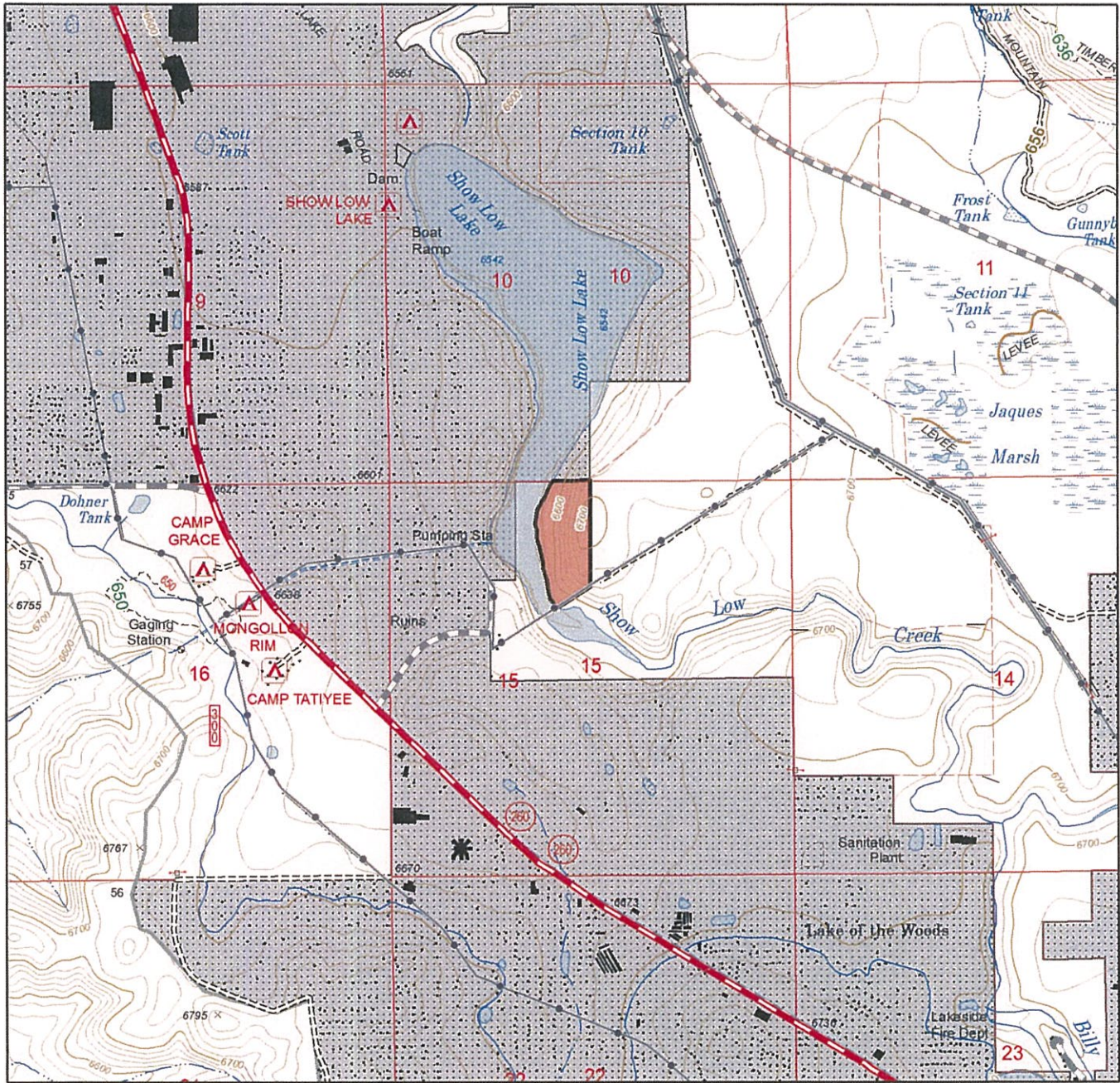

R 23 E

