

**ORDER NO. 08-18-02**  
**MENDOCINO NATIONAL FOREST**

Pursuant to 16 USC 551 and 36 CFR 261.50(a), and to provide for public safety and to protect natural resources, the following acts are prohibited within the Chico Seed Orchard (CSO) on the Mendocino National Forest. These prohibitions are effective from March 11, 2018, through March 8, 2020.

1. Being in the CSO, except the seed production orchards and study area as provided in Prohibition No. 2 below, between the hours of 7:00 p.m. and 7:00 a.m. from March 1 through October 31; and between the hours of 5:00 p.m. and 7:00 a.m. from November 1 through February 29, as shown on the attached map. 36 CFR 261.58(1).
2. Being in the Northwest Seed Production Orchard, the Northeast Seed Production Orchard, the Southwest Seed Production Orchard, the Douglas Fir Production Orchard, or the Valley Oak Provenance Study Area, as shown on the attached map. 36 CFR 261.53(e).
3. Being in the CSO with an off-leash dog. 36 CFR 261.58(s).

Pursuant to 36 CFR 261.50(e), the following persons are exempt from this Order:

1. Persons with a permit from the Forest Service specifically authorizing the otherwise prohibited act or omission.
2. Any Federal, State, or local officer, or member of an organized search and rescue or fire fighting force in the performance of an official duty.

These prohibitions are in addition to the general prohibitions contained in 36 CFR 261, Subpart A.

A violation of these prohibitions is punishable by a fine of not more than \$5,000 for an individual or \$10,000 for an organization, or imprisonment for not more than six months, or both. 16 USC 551 and 18 USC 3559, 3571, and 3581.

Done at Willows, California this 7th day of February, 2018.

  

---

ANN D. CARLSON  
Forest Supervisor  
Mendocino National Forest

This Order supersedes Order No. 08-17-30, dated November 5, 2017.

# ORDER NO. 08-18-02 MENDOCINO NATIONAL FOREST CHICO SEED ORCHARD

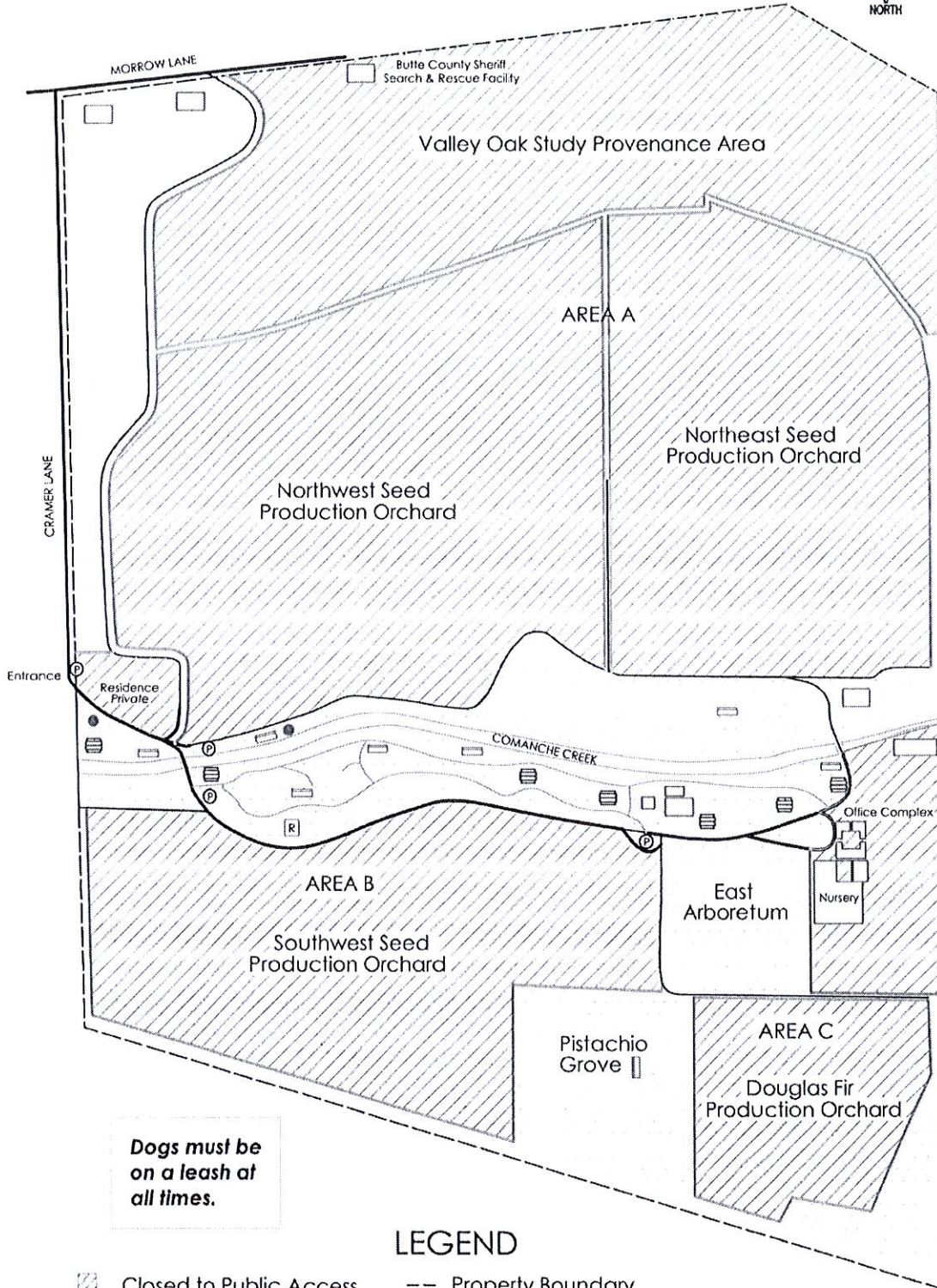

**Dogs must be on a leash at all times.**

## LEGEND

- |  |                    |                   |
|--|--------------------|-------------------|
| Closed to Public Access  | Property Boundary  | Restroom          |
| Open Public Area<br>(MAR 1st - OCT 31st: 7 AM - 7 PM)<br>(NOV 1st - FEB 29th: 7 AM - 5 PM) | Paved Nature Trail | Picnic Table      |
| Paved Road   | Building           | Bench             |
| Service Road   | Parking            | Dog Waste Station |