

SALE AREA MAP SHALLOW TWO

CHIPPEWA NATIONAL FOREST
BLACKDUCK RANGER DISTRICT

T150N-R28W T149N-R28W

Map 2 of 4
Date: 5/4/2018
By: D.W.

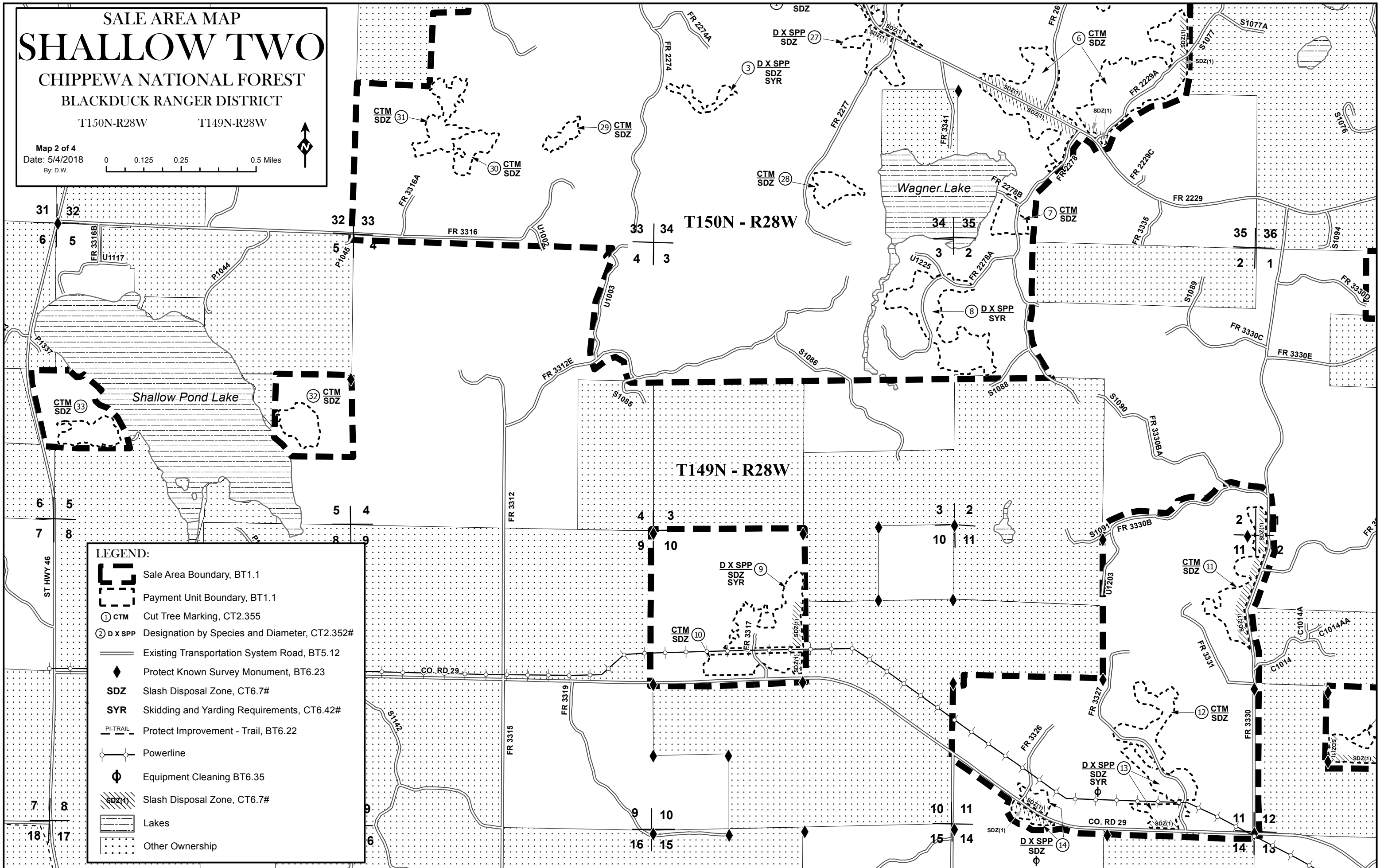
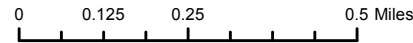

LEGEND:

- Sale Area Boundary, BT1.1
- Payment Unit Boundary, BT1.1
- ① CTM Cut Tree Marking, CT2.355
- ② D X SPP Designation by Species and Diameter, CT2.352#
- Existing Transportation System Road, BT5.12
- Protect Known Survey Monument, BT6.23
- SDZ Slash Disposal Zone, CT6.7#
- SYR Skidding and Yarding Requirements, CT6.42#
- PI-TRAIL Protect Improvement - Trail, BT6.22
- Powerline
- Equipment Cleaning BT6.35
- Lakes
- Other Ownership