

ORDER NUMBER 19-86-98

PUBLIC NUDITY
LAKE TAHOE BASIN MANAGEMENT UNIT

=====

Pursuant to 36 CFR 261.50(a) and (b), the following is prohibited in the described areas, which are under my jurisdiction:

- (1) Being publicly nude in any area shown on the attached map, or within any of the following areas:
[36 CFR 261.58(J)]

Bayview Campground
Eagle Falls Day Use Area to the Wilderness Boundary
Inspiration Point Picnic Area
Kaspian Campground and Picnic Area
Meeks Bay Campground and Picnic Area
Nevada Beach Campground and Beach
Sixty-Four Acres Beach and Day Use Area
William Kent Campground and Beach

Pursuant to 36 CFR 261.50(e), each of the following persons is exempt from this order.

This prohibition is in addition to the general prohibitions in 36 CFR, Part 261.

Done at South Lake Tahoe, California, this 18TH day of September, 1986.



RALPH C. CISCO
Forest Supervisor
Lake Tahoe Basin Management Unit

Violations of these prohibitions is punishable by a fine of not more than \$500.00 or imprisonment for not more than six months or both. See 16 USC, Section 551.

ORDER NUMBER 19-86-98

 AREA CLOSED TO
PUBLIC NUDITY

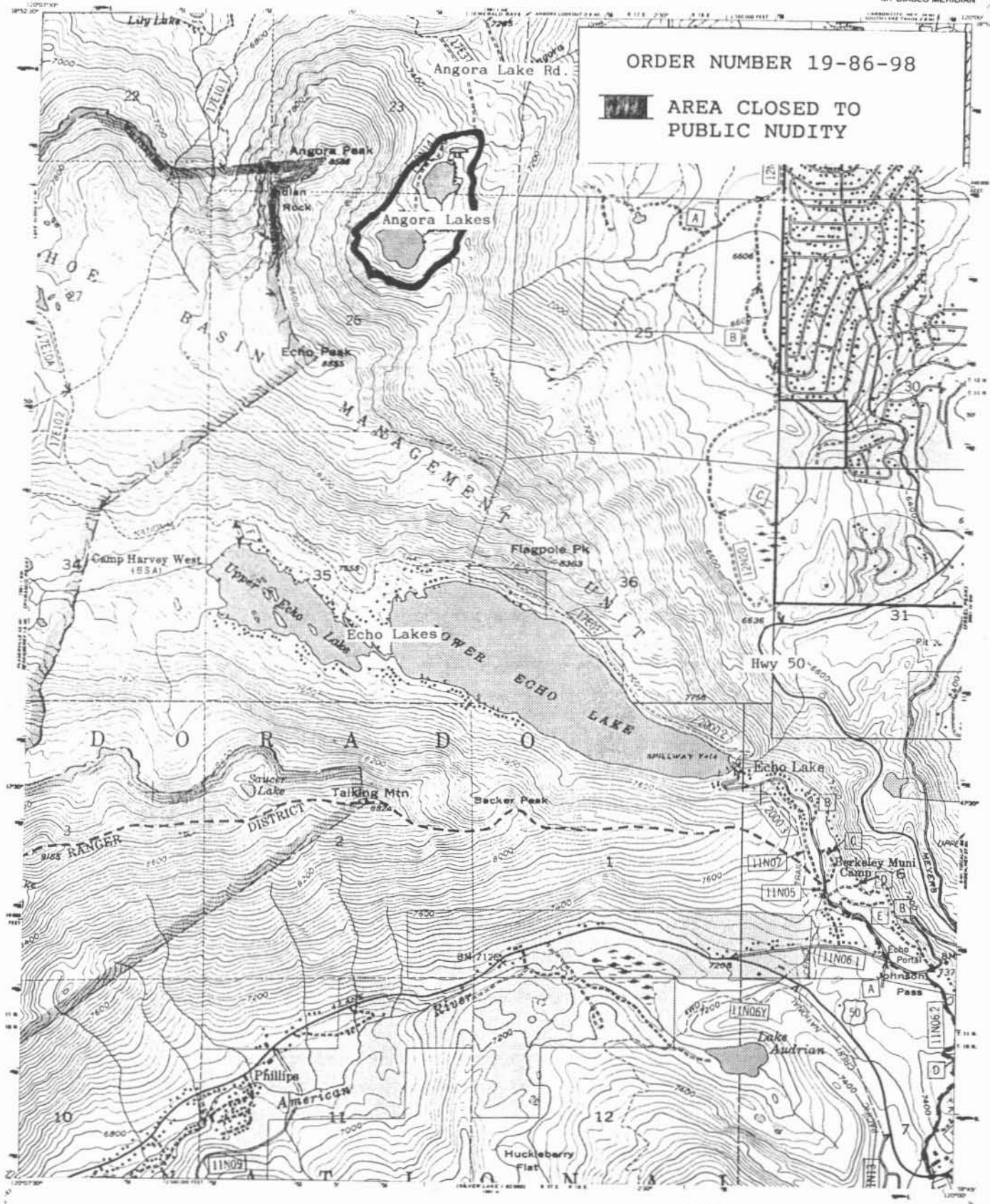

National Geographic Vertical Datum of 1929
Horizontal Projection - 1927 North American Datum
10,000 foot grid based California coordinate system using
2,000 meter Universal Transverse Mercator grid size
zone 10

MAPPED, EDITED AND PUBLISHED BY THE
U.S. GEOLOGICAL SURVEY 1988
PHOTOGRAPHIC - 1988

Prepared by the U.S. Forest Service Construction Service
Center, Salt Lake City, using 1978 field checked com-
puter guide. Revised information added using photogram-
metric methods from computer processed aerial photo-
graphs.



PRIMARY BASE SERIES MAP
ECHO LAKE, CALIFORNIA
N3845-W12000-7.5
F. S. NO. 523-4C
1978

ORDER NUMBER 19-86-98

AREA CLOSED TO
PUBLIC NUDITY

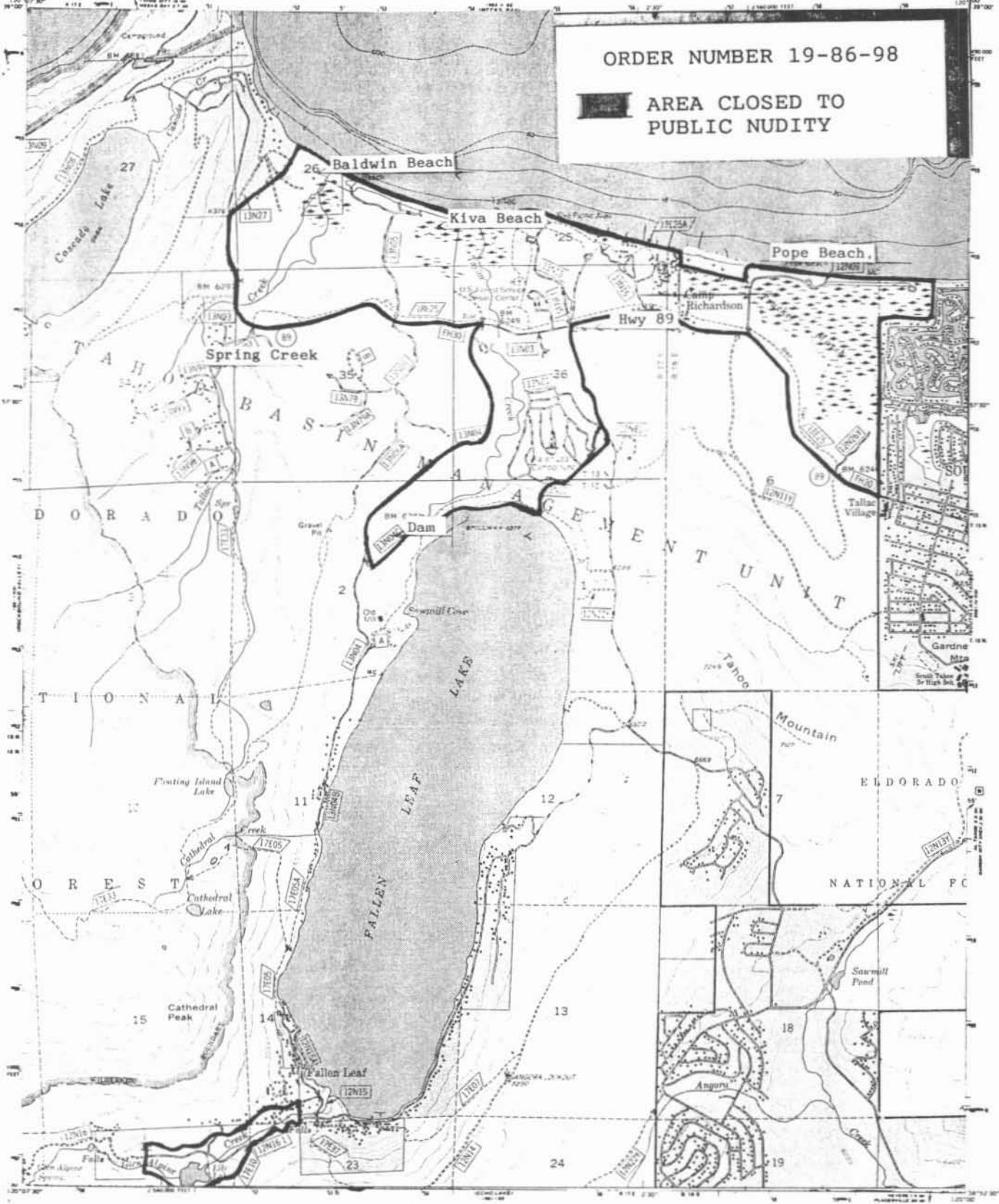

National Geographic Vertical Datum of 1985
Horizontal Projection—1983 North American Datum
1:50,000 scale grid based on California coordinate system, zone 2
1:50,000 scale Universal Transverse Mercator grid data
zone 10

MAPPED, EDITED AND PUBLISHED BY THE
U.S. GEOLOGICAL SURVEY 1986
Publication No. 100

Prepared by the U.S. Forest Service, Geospatial Service
Center, Salt Lake City utilizing 1978 field checked computer-
generated, photoreduced aerial photos (photogram-
metric), methods from information contained in Forest
Plans.

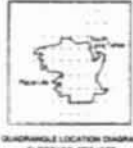

LEGEND

- Heavy Dotted Line: Heavy Duty Road
- Dashed Line: Medium Duty Road
- Thin Dashed Line: Improved Road
- Thin Solid Line: Unimproved Road
- Thin Dotted Line: Phase, Location Approximate
- Thin Solid Line: Trail, Location Approximate
- Circle with X: U.S. or State Highway
- Circle with D: Private Road or Trail
- Thin Solid Line: International Land within the National Forest
- Thin Dotted Line: Boundary as of January, 1917
- Thin Solid Line: National Forest Boundary
- Thin Dotted Line: Management Unit Boundary
- Thin Solid Line: Ranger District Boundary
- Circle with X: District Ranger Station
- Thin Solid Line: Township and Section Line Classification
- Thin Dotted Line: Surveyed, Location Reliable
- Thin Solid Line: Surveyed, Location Approximate
- Thin Dotted Line: Unsurveyed, Projection

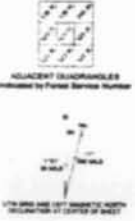

PRIMARY BASE SERIES MAP
EMERALD BAY, CALIFORNIA
N34S2 5-W12000-17.5
F. S. NO. 523-1C
1978