



Forest
Service

Lake Tahoe Basin
Management Unit

35 College Drive
South Lake Tahoe, CA 96150
(530) 543-2600
(530) 543-0956 TTY

File Code: 2520

Date: April 23, 2013

Subject: Meyers Landfill Area and Road Closures

To: Note to File

From: Nancy Gibson, Forest Supervisor 

I intend to issue two Forest Orders to continue the closure of the Meyers Landfill Area and Forest Road No. 1204 to the public.

The purpose of this action is to ensure public health and safety while providing time for cleanup in a response action pursuant to the Comprehensive Environmental Response Compensation, and Liability Act ("CERCLA"), 42 U.S.C § 9604, Federal Executive Order 12580 as amended, and 7 C.F.R. § 2.60 (a)(40), for the property known as Meyers Landfill. The area and road affected is shown on the attached map. Order No. 19-13-01, which closes the Meyers Landfill Area and Forest Road No. 1204 (also known as Garbage Dump Road), will be in effect from May 1, 2013, through October 15, 2013 and May 1, 2014 through October 15, 2014. Order No. 19-13-02, which closes only the Meyers Landfill Area during the winterized period, will be in effect from October 16, 2013 through April 30, 2014 and October 16, 2014 through April 30, 2015. These closures are based on the Time Critical Action Memorandum and the additional analysis and documentation in the project record.

While the construction of the landfill cap and associated surface water controls (Remedial Action for Operable Unit 1) was almost completed in October of 2012, additional construction and revegetation efforts are planned for summer 2013 to repair erosive damage within the Meyers Landfill Area. The construction activities will cause significant hazards to public safety both within the Meyers Landfill Area and along Forest Road No. 1204. During the interim winterized period, hazards to public safety will remain within the Meyers Landfill Area including steep irregular slopes and slumping soils, and partially buried fencing, metal standpipes, concrete bollards, wiring and cabling. These hazards have high potential to cause injuries or fatalities to people not trained and engaged in the procedures necessary to mitigate these risks.

I have concluded that this decision may be categorically excluded from documentation in an Environmental Impact Statement (EIS) or Environmental Assessment (EA) under the National Environmental Policy Act. This action falls within the category identified in 36 CFR 220.6(d)(1) – prohibitions to provide short-term resource protection or to protect public health and safety – and does not require documentation in a decision memo, decision notice, or record of decision. Pursuant to 36 C.F.R. § 215.12(f), this decision is not subject to administrative appeal. I have determined that there are no extraordinary circumstances associated with this temporary closure and the procedures for legal notice and opportunity to comment (36 CFR 215.4) do not apply to this project. Implementation of the decision may begin immediately.





ORDER NO. 19-13-01
USDA FOREST SERVICE
LAKE TAHOE BASIN MANAGEMENT UNIT
MEYERS LANDFILL AREA and ROAD CLOSURE



Pursuant to 16 USC 55 1 and 36 CFR 261.50(a) and (b), and to provide for public safety, the following acts are prohibited within the Lake Tahoe Basin Management Unit. This Order is effective from May 1, 2013 through October 15, 2013 and May 1, 2014 through October 15, 2014.

1. Going into or being upon the Meyers Landfill Closure Area. The Meyers Landfill Closure Area boundary begins at the intersection of Forest Road No. 1204 and Pioneer Trail, then continues due east for approximately 3000 feet to Saxon Creek, then continues northward along Saxon Creek to Forest Road No. 12N08, then continues westward along Forest Road No. 12N08 to Forest Road No. 1204, then continues southward along Forest Road No. 1204 back to the starting point, as shown on Exhibit A. 36 CFR 261.53(e).
2. Being on Forest Road No. 1204 (Garbage Dump Rd.). 36 CFR 261.54(e).

Pursuant to 36 CFR 26 1.50(e), the following persons are exempt from this Order:

1. Persons with a permit from the Forest Service specifically authorizing the otherwise prohibited act or omission.
2. Any Federal, State or local officer or member of an organized rescue or firefighting force in the performance of an official duty.
3. EI Dorado County employees, and contractors and subcontractors of EI Dorado County, engaged in operations authorized by the Forest Service within the Meyers Landfill Closure Area.

These prohibitions are in addition to the general prohibitions in 36 CFR Part 261, Subpart A.

A violation of these prohibitions is punishable by a fine of not more than \$5,000 for an individual or \$10,000 for an organization, or imprisonment for not more than six months, or both. 16 USC 551 and 18 USC 3559, 3571 and 3581.

Done at South Lake Tahoe, California, this 23 day of April, 2013.

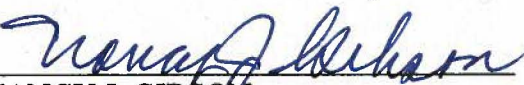
NANCY J. GIBSON
Forest Supervisor,
Lake Tahoe Basin Management Unit



ORDER NO. 19-13-02
USDA FOREST SERVICE
LAKE TAHOE BASIN MANAGEMENT UNIT
MEYERS LANDFILL AREA and ROAD CLOSURE



Pursuant to 16 USC 55 1 and 36 CFR 261.50(a) and (b), and to provide for public safety, the following acts are prohibited within the the Lake Tahoe Basin Management Unit. This Order is effective from October 16, 2013 through April 30, 2014 and October 16, 2014 through April 30, 2015.

Going into or being upon the Meyers Landfill Closure Area. The Meyers Landfill Closure Area boundary begins at the intersection of Forest Road No. 1204 and Pioneer Trail, then continues due east for approximately 3000 feet to Saxon Creek, then continues northward along Saxon Creek to Forest Road No. 12N08, then continues westward along Forest Road No. 12N08 to Forest Road No. 1204, then continues southward along Forest Road No. 1204 back to the starting point, as shown on Exhibit A. 36 CFR 261.53(e).

Pursuant to 36 CFR 26 1.50(e), the following persons are exempt from this Order:

1. Persons with a permit from the Forest Service specifically authorizing the otherwise prohibited act or omission.
2. Any Federal, State or local officer or member of an organized rescue or firefighting force in the performance of an official duty.
3. EI Dorado County employees, and contractors and subcontractors of EI Dorado County, engaged in operations authorized by the Forest Service within the Meyers Landfill Closure Area.

This prohibition is in addition to the general prohibitions in 36 CFR Part 261, Subpart A.

A violation of this prohibition is punishable by a fine of not more than \$5,000 for an individual or \$10,000 for an organization, or imprisonment for not more than six months, or both. 16 USC 551 and 18 USC 3559, 3571 and 3581.

Done at South Lake Tahoe, California, this 23 day of April, 2013.

NANCY J. GIBBON
Forest Supervisor,
Lake Tahoe Basin Management Unit

Exhibit A

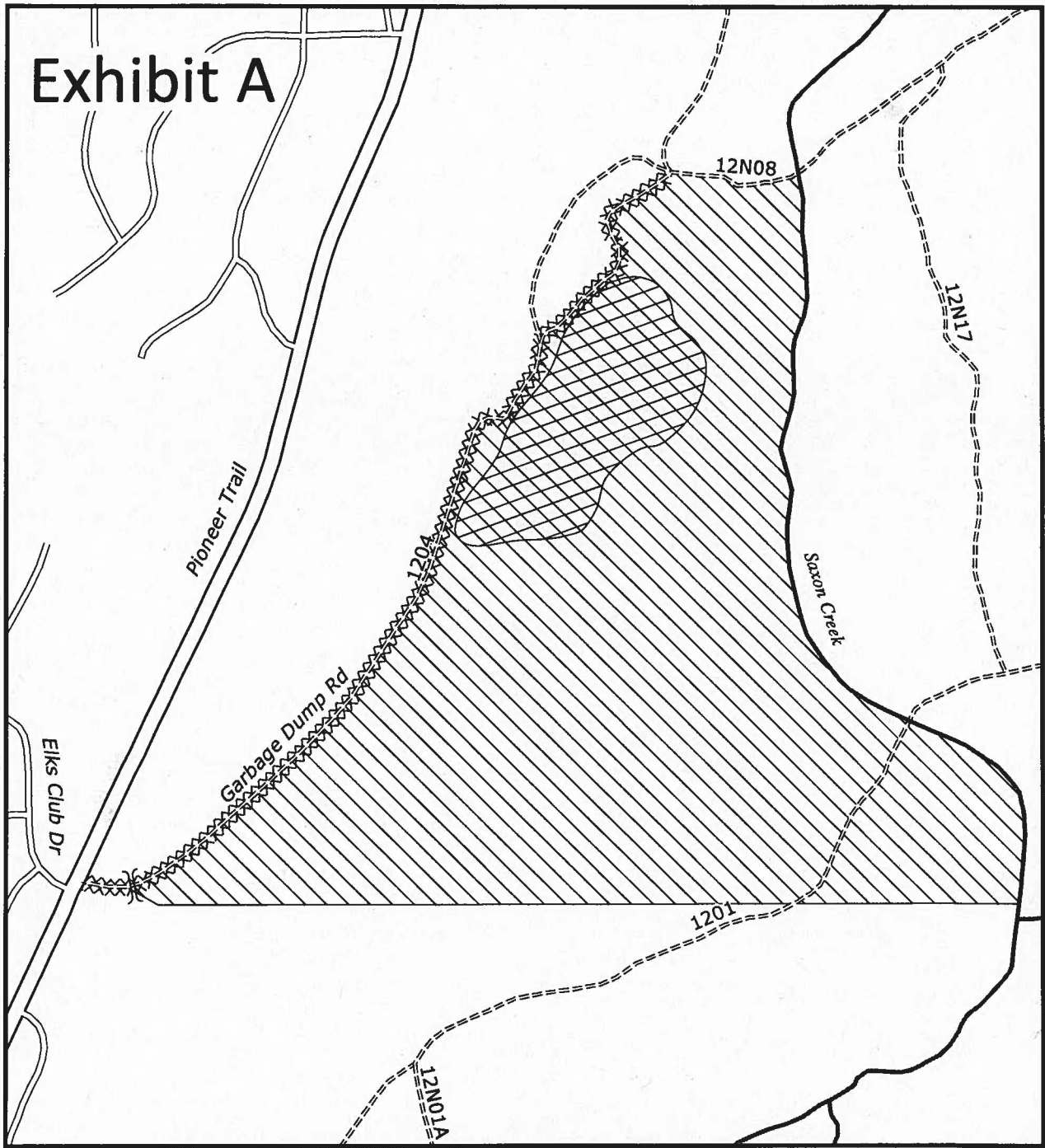

MEYERS LANDFILL CLOSURE MAP

Lake Tahoe Basin Management Unit, Forest Orders 19-13-01 & 19-13-02



Closed Area (Year-round)



Meyers Landfill Site

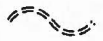

FS System Roads



Creek



Closed Road (May 1 - Oct 15)

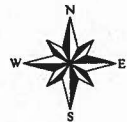

0 500 1,000 Feet