

# Motor Vehicle Use Map 2024-2025

Bienville Ranger District  
Bienville National Forest  
Mississippi



United States  
Department of Agriculture  
Forest Service  
Southern Region

# Motor Vehicle Use Map 2024-2025



## THE PURPOSE AND CONTENTS OF THIS MAP

This map dated 09/01/2024 shows the National Forest System roads, National Forest System trails, and the areas on National Forest System lands in the Bienville National Forest that are designated for motor vehicle use pursuant to 36 CFR 212.51. The map contains a list of those designated roads, trails, and areas that enumerates the types of vehicles allowed on each route and in each area and any seasonal restrictions that apply on those routes and in those areas.

Designation of a road, trail, or area for motor vehicle use by a particular class of vehicle under 36 CFR 212.51 should not be interpreted as encouraging or inviting use, or to imply that the road, trail, or area is passable, actively maintained, or safe for travel. Motor vehicle designations include parking along designated routes and at facilities associated with designated routes when it is safe to do so and when not causing damage to National Forest System resources. Seasonal weather conditions and natural events may render designated roads and trails impassable for extended periods. Designated areas may contain dangerous or impassable terrain. Many designated roads and trails may be passable only by high-clearance vehicles or four-wheel drive vehicles. Maintenance of designated roads and trails will depend on available resources, and many may receive little maintenance.

This motor vehicle use map identifies those roads, trails, and areas designated for the motor vehicle use under 36 CFR 212.51 for the purpose of enforcing the prohibition at 36 CFR 261.13. This is a limited purpose. The other public roads are shown for information and navigation purposes only and are not subject to designation under the Forest Service travel management regulation.

**These designations apply only to National Forest System roads, National Forest System trails, and areas on National Forest System lands.**

## PROHIBITIONS

**It is prohibited to possess or operate a motor vehicle on National Forest System lands on the Bienville National Forest other than in accordance with these designations (36 CFR 261.13).**

Violations of 36 CFR 261.13 are subject to a fine of up to \$5,000 or imprisonment for up to 6 months or both (18 U.S.C. 3571(e) This prohibition applies regardless of the presence or absence of signs.

This map does not display nonmotorized uses, over-snow uses, or other facilities and attractions on the Bienville National Forest. Obtain a forest visitor map for more complete information.

Designated roads, trails, and areas may also be subject to temporary, emergency closures, and visitors must comply with signs notifying them of such restrictions. A national forest may issue an order to close a road, trail, or area on a temporary basis to protect the life, health, or safety of forest visitors or the natural or cultural resources in these areas. Such temporary and/or emergency closures are consistent with the Travel Management Rule (36 CFR 212.52 (b) 36 CFR 261 subpart B.

The designation "road or trail open to all motor vehicles" does not supersede vehicle size or weight limits imposed through State traffic law.

## INFORMATION SOURCES

Bienville National Forest  
3473 Hwy 35 S.  
Forest, MS 39074  
(601) 469-3811

Bienville National Forest Web Site  
<http://fs.usda.gov/mississippi/>

National Forests in Mississippi  
Forest Supervisor's Office  
6425 Lakeover Road Suite A,  
Jackson, MS 39213  
Phone (601) 965-1600

## OPERATOR RESPONSIBILITIES

Operating a motor vehicle on National Forest System roads, National Forest System trails, and in areas on National Forest System lands carries a greater responsibility than operating that vehicle in a city or other developed setting. Not only must the motor vehicle operators know and follow all applicable traffic laws, but they also need to show concern for the environment as well as other forest users. The misuse of motor vehicles can lead to the temporary or permanent closure of any designated road, trail, or area. Operators of motor vehicles are subject to State traffic law, including State requirements for licensing, registration, and operation of the vehicle in question.

Motor vehicle use, especially off-highway vehicle use, involves inherent risks that may cause property damage, serious injury, and possibly death to participants. Riders should drive cautiously and anticipate rough surfaces and features such as snow, mud, vegetation, and water crossings common to remote driving conditions. Participants voluntarily assume full responsibility for these damages, risks, and dangers. Motor vehicle operators should take care at all times to protect themselves and those under their responsibility.

Much of the Bienville National Forest is remote, and medical assistance may not be readily available. Cellular telephones do not work in many areas of the Bienville National Forest. Operators should take adequate food, water, first aid supplies, and other equipment appropriate for the conditions and expected weather.

**ALWAYS REMEMBER TO RESPECT PRIVATE LAND! PROTECT YOUR PRIVILEGE. STAY ON DESIGNATED ROADS, TRAILS, AND IN DESIGNATED AREAS.**

Read and understand this map in its entirety. If you have questions, please contact the Bienville National Forest for clarification.

Road, trail, and area users must comply with this map, as well as all Federal, State, and local laws and regulations. Compliance with these rules is the responsibility of the user.



The U.S. Department of Agriculture (USDA) prohibits discrimination in all its programs and activities on the basis of race, color, national origin, age, disability, and where applicable, sex, marital status, familial status, parental status, religion, sexual orientation, genetic information, political beliefs, reprisal, or because all or part of an individual's income is derived from any public assistance program. (Not all prohibited bases apply to all programs.) Persons with disabilities who require alternative means for communication of program information (Braille, large print, audiotape, etc.) should contact USDA's TARGET Center at (202) 720-2600 (voice and TDD). To file a complaint of discrimination, write to USDA, Director, Office of Civil Rights, 1400 Independence Avenue, S.W., Washington, D.C. 20250-9410, or call (800) 795-3272 (voice) or (202) 720-6382 (TDD). USDA is an equal opportunity provider and employer.

## EXPLANATION OF LEGEND ITEMS

to Highway Legal Vehicles Only:

These roads are open only to motor vehicles licensed under State law for general operation on all public roads within the State.

Special Vehicle Designation:

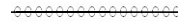

This symbol indicates that the road or trail is open to classes of vehicles other than those listed above. Refer to the Seasonal and Special Designation Table for further instructions.

Seasonal Designation:



This symbol, used in conjunction with one of the other road or trail symbols, indicates that the road or trail is open only during certain portions of the year. Refer to the Seasonal and Special Designation Table for further instructions.

Game Retrieval:



This symbol is used along with a designated road or trail to indicate that limited cross-country motor vehicle use is allowed within a specific distance of that route, solely for the purpose of game retrieval. Refer to the Game Retrieval Table for specifics.

District Ranger, Enoree Ranger District

## IN CASE OF EMERGENCY, CONTACT:

**County Sheriff's Departments:**

Jasper - 601-764-2588

Newton - 601-635-2101

Scott - 601-469-1511

Smith - 601-782-4531

or  
Dial 911



**Bienville Ranger District  
Bienville National Forest  
Motor Vehicle Use Map Index**

**VICINITY MAP**

National Forests  
in  
Mississippi

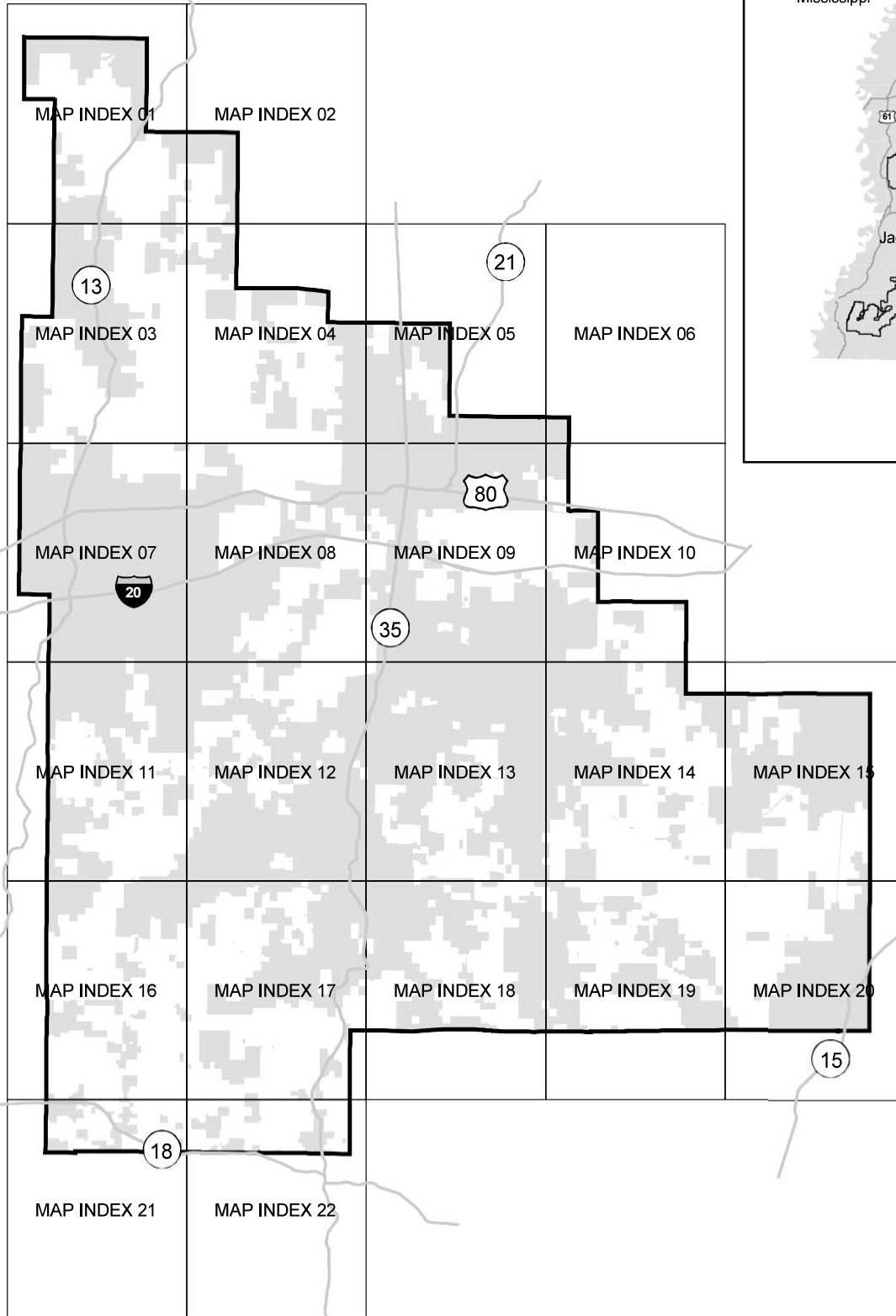
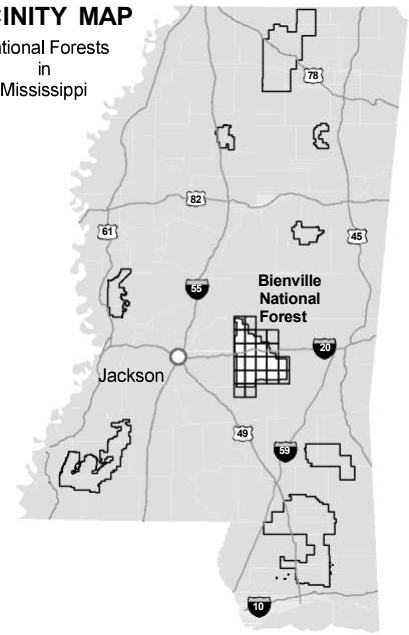

## **BIG GAME RETRIEVAL CORRIDORS**

When a big game animal has been legally taken, the individual who legally took the animal may drive or be driven to the downed animal. Under no circumstances may a second vehicle be used to retrieve the animal. The vehicle driven to the animal should be of sufficient capacity that only one trip is necessary. The number of individuals who participate in the retrieval is limited by the vehicle's capacity, and the willingness of others to walk to and from the downed animal.

The vehicle used to retrieve the game may be operated off the route up to the distance specified on the MVUM. If the downed game is further than the allowed distance, the vehicle may be driven only the specified distance from the designated route.



**Within game retrieval corridors, these are closed to motor vehicle use:**

Powerlines, pipelines, streams, lakes, dams, Botanical and Research Natural Areas, Non-motorized trails.

**No loaded firearms allowed while operating an OHV.**

Route Number	Distance/ side of the road	Vehicle Type/ Legend Symbol	Dates Allowed
500, 503D, 503F, 504O, 504P, 506, 506A, 506C, 507A, 507A1, 507A2, 507B, 507C, 507F, 507G, 508, 508A, 508F, 508M, 508N, 511, 513, 513E, 517A, 517B, 518, 530, 532A, 535, 535A, 536, 536C, 538A, 538A1, 538C, 538J, 543, 547C, 548, 550, 551C, 554A, 558A, 558A1, 562, 562A, 563A, 5094	1.5 miles from center line of road, only on lands that are currently National Forest System lands that are also Wildlife Management Area lands.	Wheeled non-highway legal vehicles less than or equal to 50 inches in width. . . . . .	10/01-01/31

## **Seasonal and Special Vehicle Designations**

Route Number	Legend	Special Vehicle Designation	Dates Allowed
503D, 506A, 506C, 507A, 507A2, 507B, 507C, 507F, 507G, 508N, 517B, 518, 527D, 530, 530A, 532A, 538C, 538J, 547C	 Roads open to highway legal vehicles only, with Seasonal Designation	Seasonal Designation	09/15-04/30
508D, 522A, 535, 535A, 537, 538B, 550, 550A, 574, 528, 528A, 528B, 528C, 538A	 Special Vehicle Designation	Wheeled non-highway legal vehicles less than or equal to 50 inches in width	01/01-12/31

## **Exclusion for Turkey Season Walk In Area Designation**

Route Number	Description of affected portion of road	Special Vehicle Designation	Dates Allowed for this portion of road
506A	1.3 mile from FS 506 to dead end of road	Seasonal Allow Designation is excluded on Portions of the road during designated time surrounding turkey hunting seasons of March 08 - May 01 Contact Bienville Ranger District for more information	09/15-02/22
506C	1.2 mile from posted closure order to dead end of road		
507A2	1.0 mile from posted closure order to dead end of road		
507C	1.0 mile from FS 507 to dead end of road		
517B	1.3 mile from posted closure order to dead end of road		
532A	1.7 mile from Road 506 to dead end of road		
547C	1.2 mile from posted closure order to dead end of road		



# Motor Vehicle Use Map 2024-2025

MAP INDEX 1

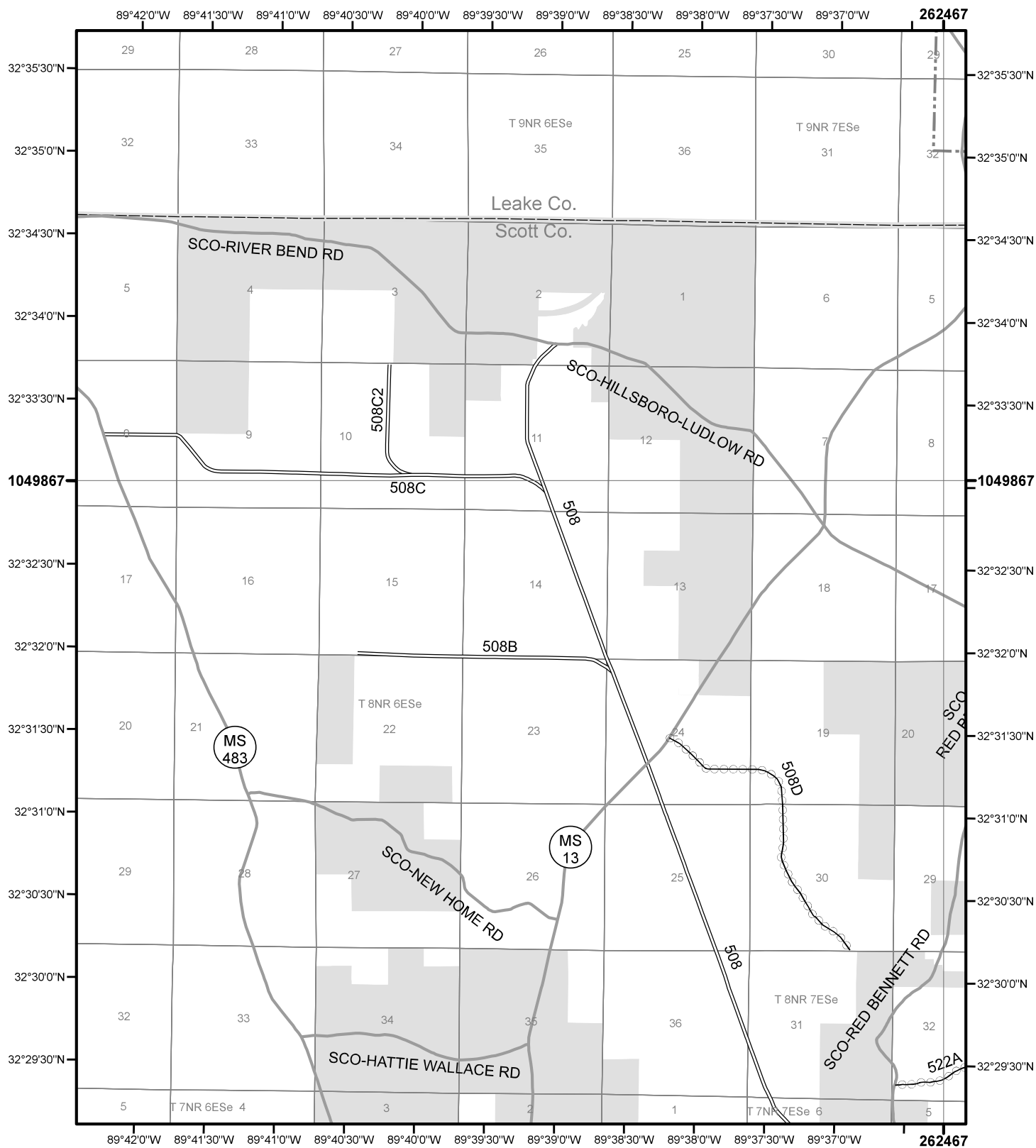

North American Datum of 1927 (NAD 27)  
State Plane, Mississippi East Zone, FIPS 2301

FS-873-807

## Map Index

• •	Game Retrieval (See Table) (Used along with road and trail symbols listed above)		Forest or Unit Boundary
	Roads Open to Highway Legal Vehicles Only		Non-National Forest System Lands within this National Forest
	Special Vehicle Designation (See Table)		Lakes
	Interstate		
	Other Public Roads		
	Seasonal Designation (See Table) (Used along with road or trail listed above)		

**LEGEND**

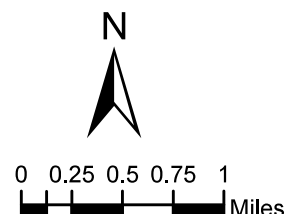
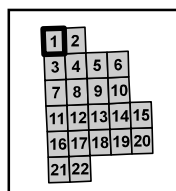



# Motor Vehicle Use Map 2024-2025

## MAP INDEX 2

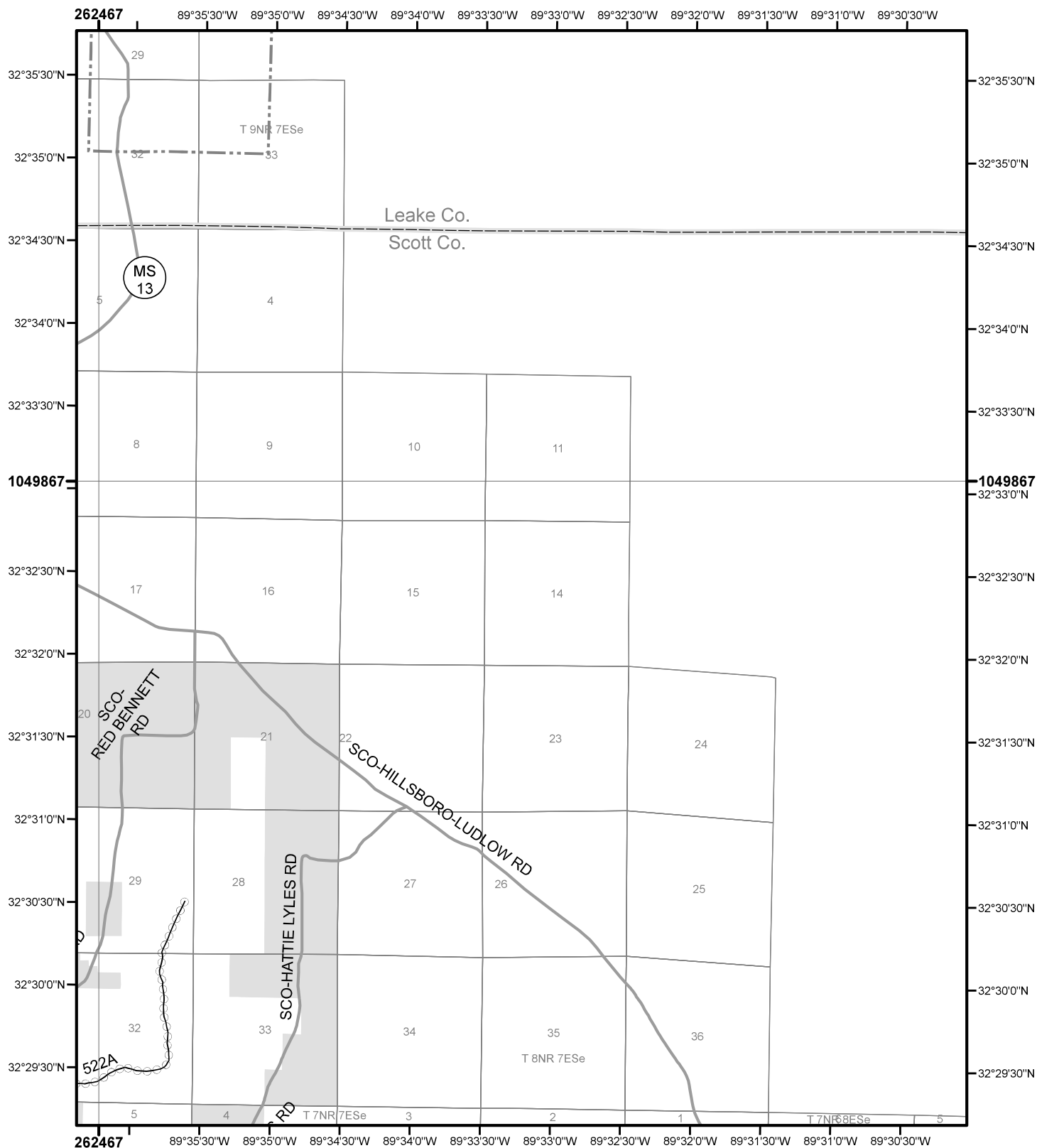

North American Datum of 1927 (NAD 27)  
State Plane, Mississippi East Zone, FIPS 2301

FS-873-807

### Map Index

• •	Game Retrieval (See Table) (Used along with road and trail symbols listed above)		Forest or Unit Boundary
	Roads Open to Highway Legal Vehicles Only		Non-National Forest System Lands within this National Forest
	Special Vehicle Designation (See Table)		Lakes
	Interstate		
	Other Public Roads		
	Seasonal Designation (See Table) (Used along with road or trail listed above)		

## LEGEND

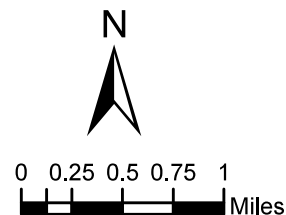
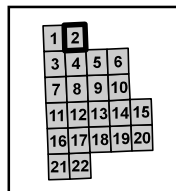



# Motor Vehicle Use Map 2024-2025

MAP INDEX 3

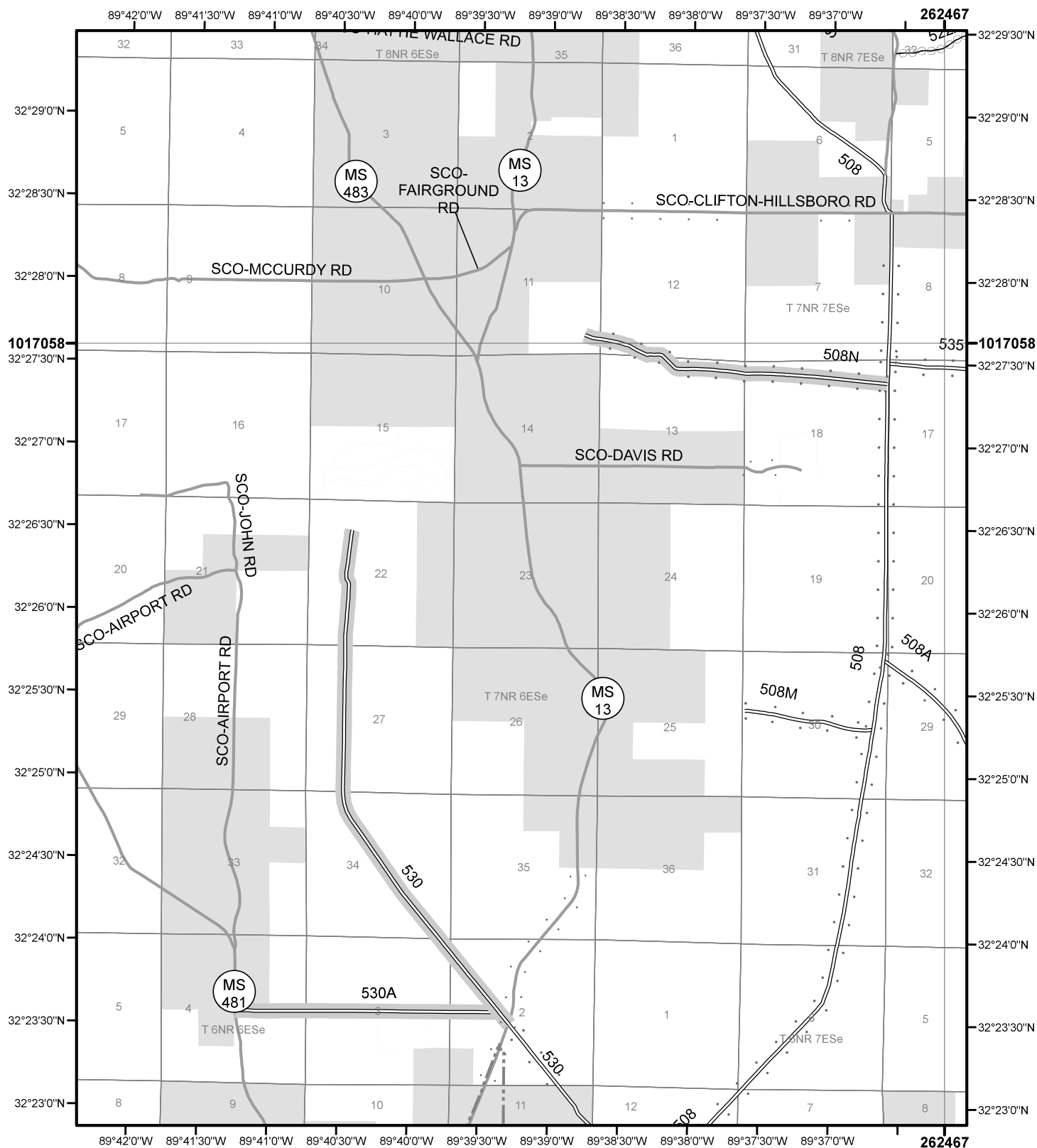

North American Datum of 1927 (NAD 27)  
State Plane, Mississippi East Zone, FIPS 2301

FS-873-807

- • Game Retrieval (See Table)  
(Used along with road and trail symbols listed above)
- Roads Open to Highway Legal Vehicles Only
- - - Special Vehicle Designation (See Table)
- Interstate
- Other Public Roads
- Seasonal Designation (See Table)  
(Used along with road or trail listed above)

Forest or Unit Boundary

Non-National Forest System Lands  
within this National Forest

Lakes

LEGEND

## Map Index

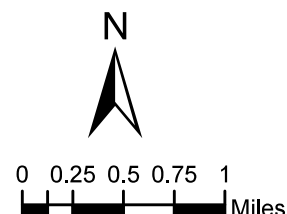
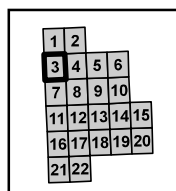



# Motor Vehicle Use Map 2024-2025

MAP INDEX 4

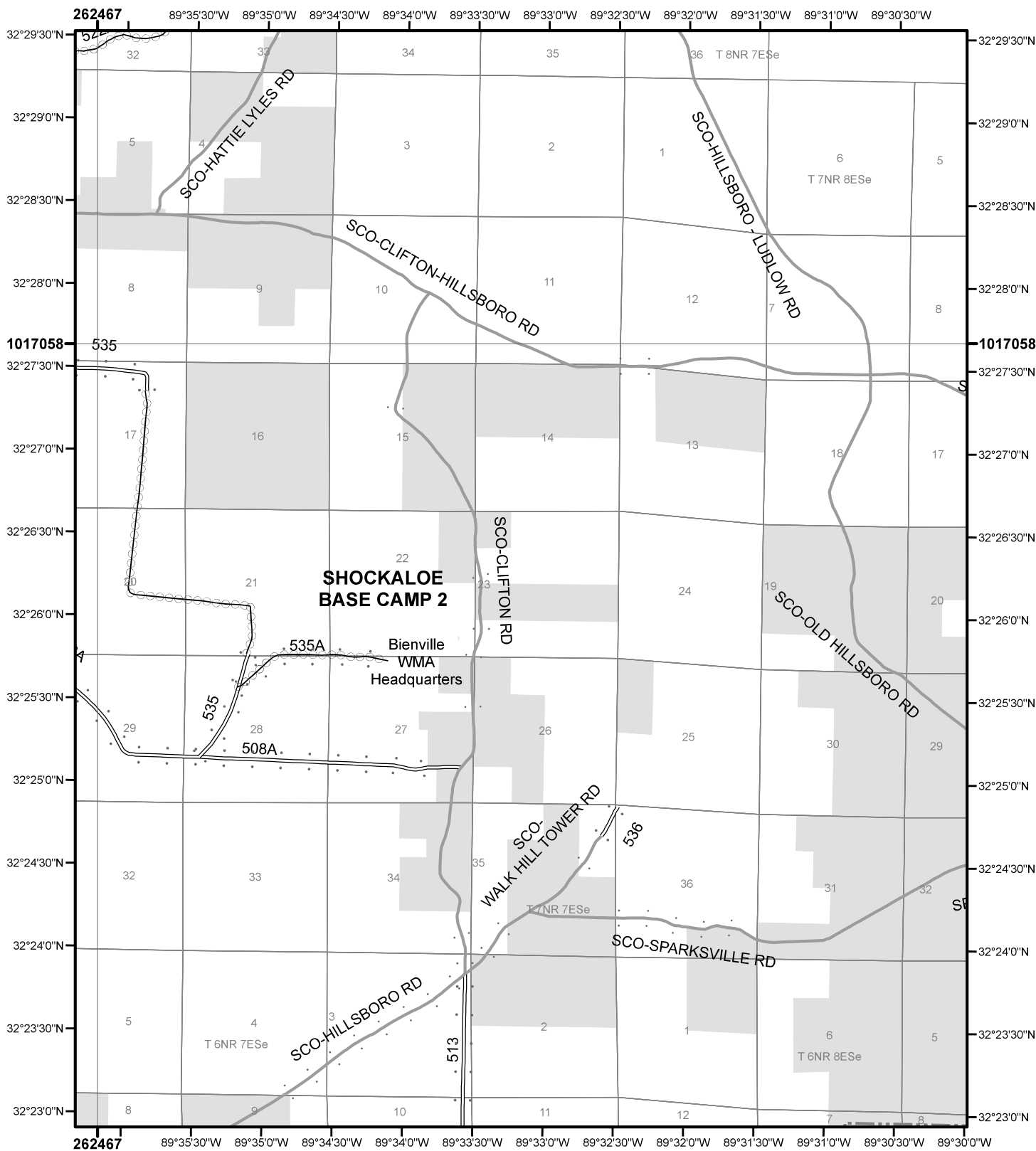

North American Datum of 1927 (NAD 27)  
State Plane, Mississippi East Zone, FIPS 2301

FS-873-807

## Map Index

- • Game Retrieval (See Table)  
(Used along with road and trail symbols listed above)
- Roads Open to Highway Legal Vehicles Only
- Special Vehicle Designation (See Table)
- Interstate
- Other Public Roads
- Seasonal Designation (See Table)  
(Used along with road or trail listed above)

- Forest or Unit Boundary
- Non-National Forest System Lands within this National Forest
- Lakes

# LEGEND

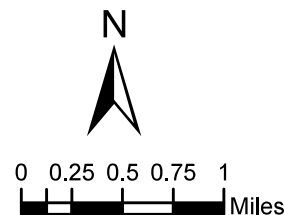
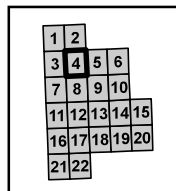





# Motor Vehicle Use Map 2024-2025

## MAP INDEX 5

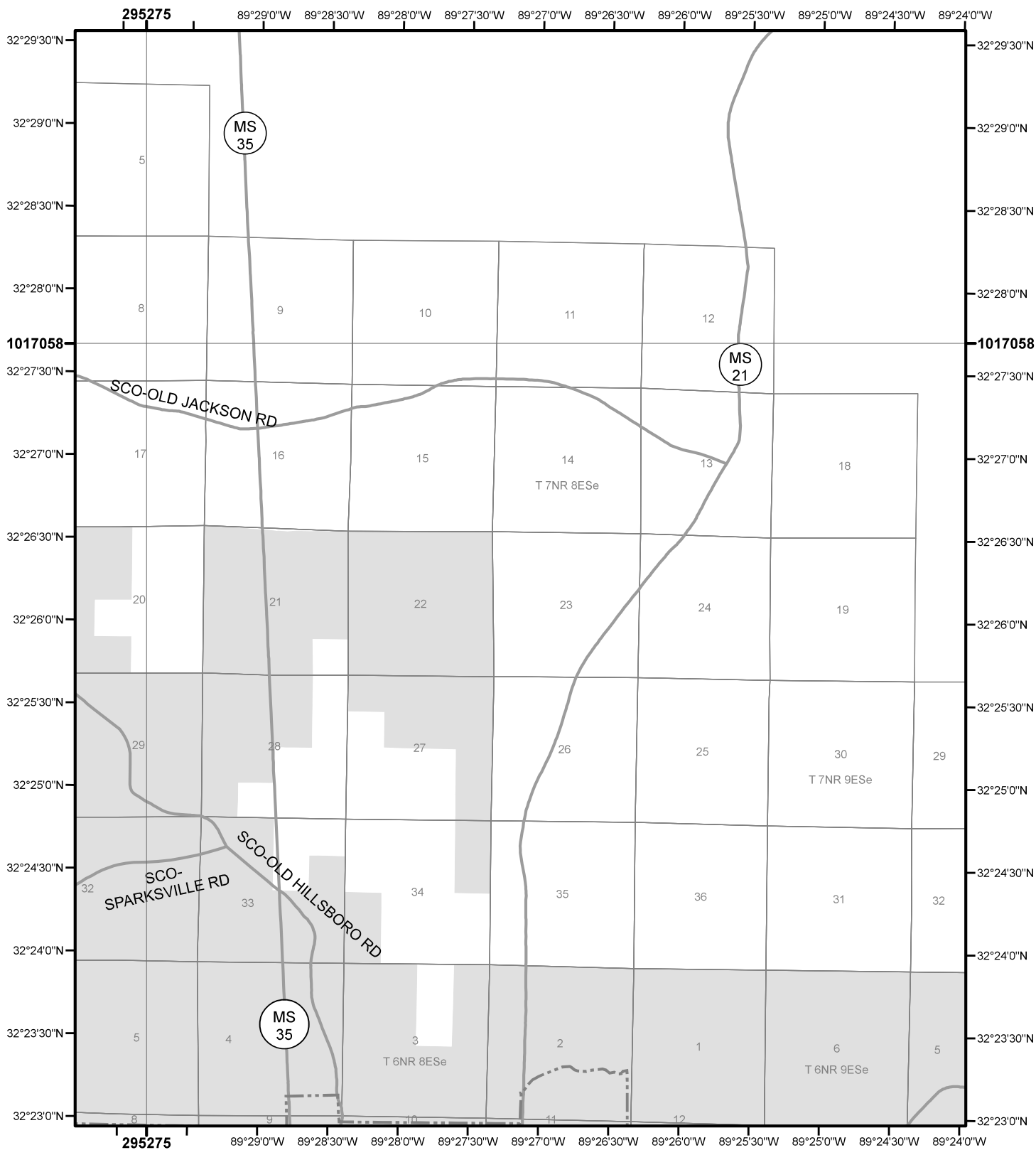

North American Datum of 1927 (NAD 27)  
State Plane, Mississippi East Zone, FIPS 2301 FS-873-807

- • Game Retrieval (See Table)  
(Used along with road and trail symbols listed above)
- ==== Roads Open to Highway Legal Vehicles Only
- ==== Special Vehicle Designation (See Table)
- ==== Interstate
- ==== Other Public Roads
- Seasonal Designation (See Table)  
(Used along with road or trail listed above)

- Forest or Unit Boundary
- Non-National Forest System Lands within this National Forest
- Lakes



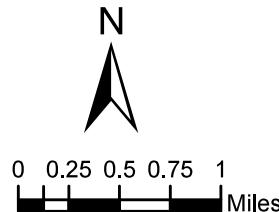
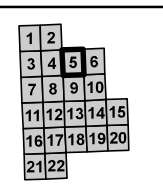

LEGEND

### Map Index





## Map Index

• •	Game Retrieval (See Table)
• •	{Used along with road and trail symbols listed above}
	Roads Open to Highway Legal Vehicles Only
	Special Vehicle Designation (See Table)
	Interstate
	Other Public Roads
	Seasonal Designation (See Table)
	{Used along with road or trail listed above}



Forest or Unit Boundary

### Non-National Forest System Lands within this National Forest

## Lakes

## LEGEND

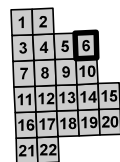



# Motor Vehicle Use Map 2024-2025

## MAP INDEX 7

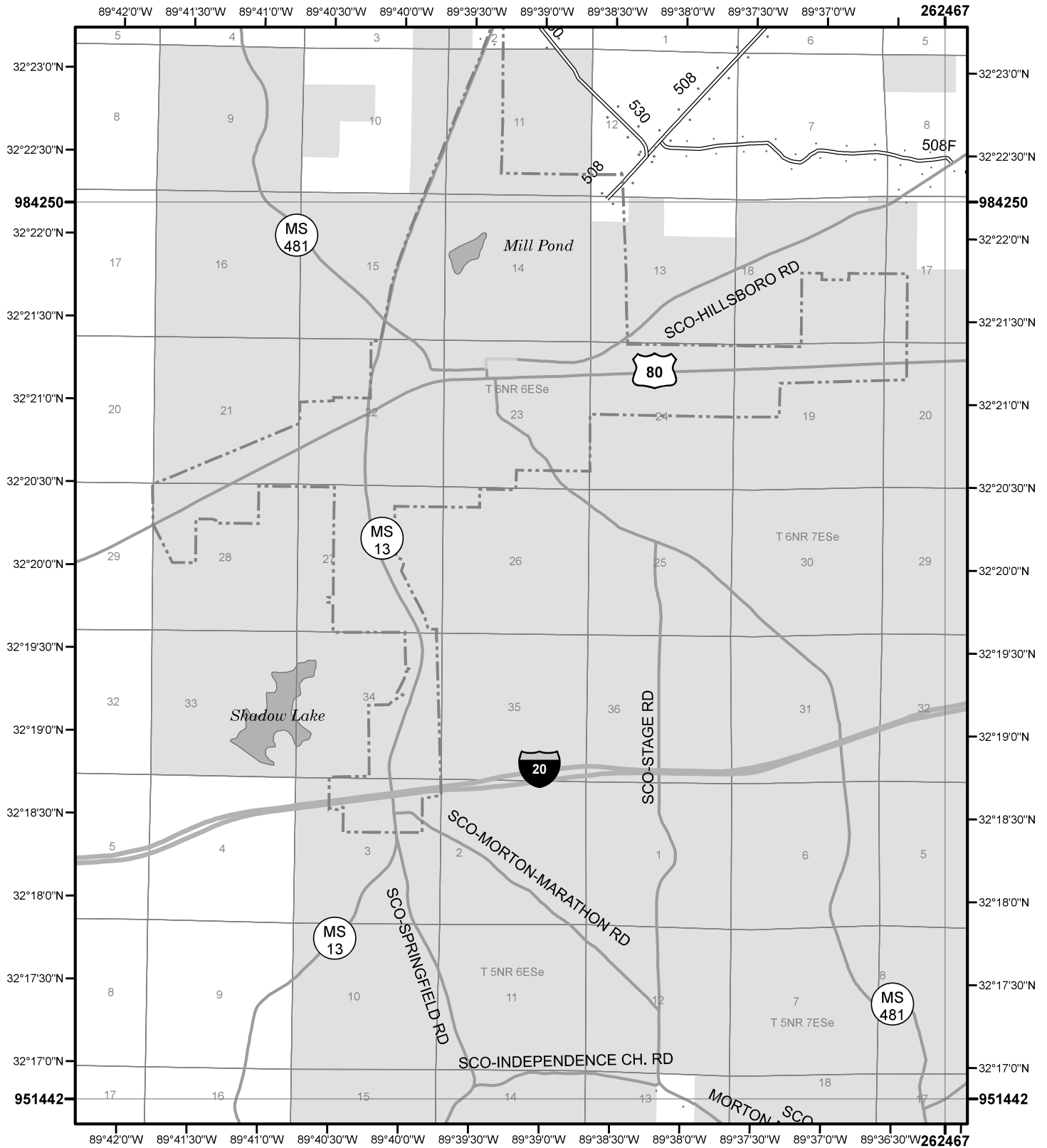

North American Datum of 1927 (NAD 27)  
State Plane, Mississippi East Zone, FIPS 2301

FS-873-807

- • Game Retrieval (See Table)  
(Used along with road and trail symbols listed above)
- Roads Open to Highway Legal Vehicles Only
- Special Vehicle Designation (See Table)
- Interstate
- Other Public Roads
- Seasonal Designation (See Table)  
(Used along with road or trail listed above)

Forest or Unit Boundary

Non-National Forest System Lands  
within this National Forest

Lakes

LEGEND

### Map Index

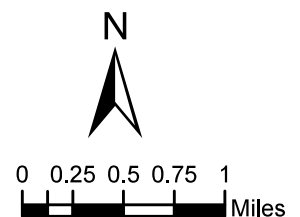
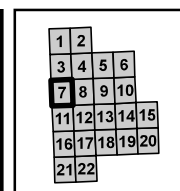







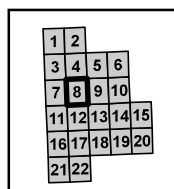



FS-873-807

## Map Index



- |   |   |   |  |
|---|---|---|--|
| • •   | Game Retrieval (See Table)                            |  | Forest or Unit Boundary                                      |
| • •   | {Used along with road and trail symbols listed above} |   |  |
|  | Roads Open to Highway Legal Vehicles Only             |  | Non-National Forest System Lands within this National Forest |
|  | Special Vehicle Designation (See Table)               |  | Lakes  |
|  | Interstate  |   |  |
|  | Other Public Roads                                    |   |  |
|  | Seasonal Designation (See Table)                      |   |  |
|   | {Used along with road or trail listed above}          |   |  |



# Motor Vehicle Use Map 2024-2025

MAP INDEX 9

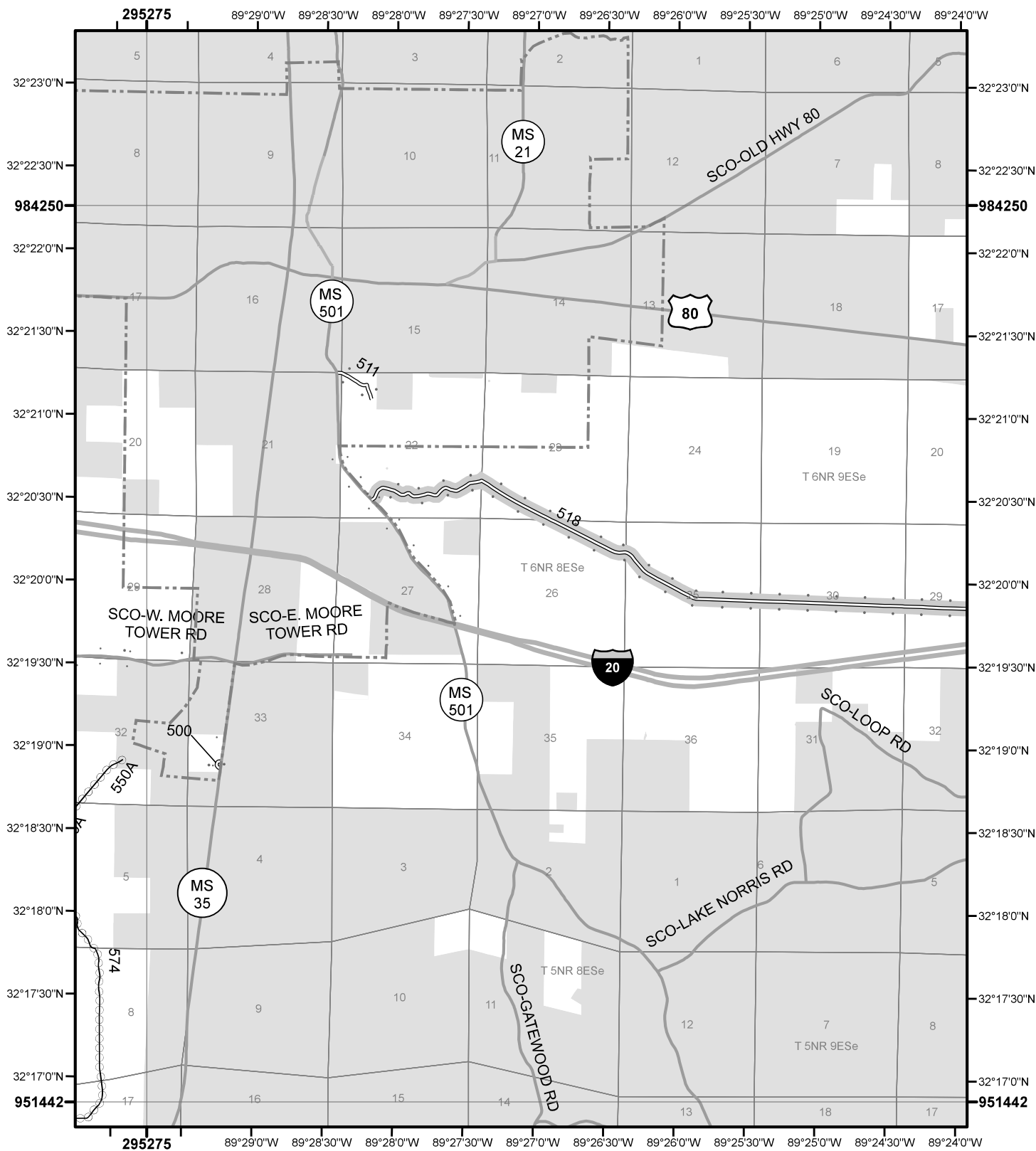

North American Datum of 1927 (NAD 27)  
State Plane, Mississippi East Zone, FIPS 2301 FS-873-807

- • Game Retrieval (See Table)  
(Used along with road and trail symbols listed above)
- Roads Open to Highway Legal Vehicles Only
- Special Vehicle Designation (See Table)
- Interstate
- Other Public Roads
- Seasonal Designation (See Table)  
(Used along with road or trail listed above)

- Forest or Unit Boundary
- Non-National Forest System Lands within this National Forest
- Lakes

**LEGEND**

## Map Index

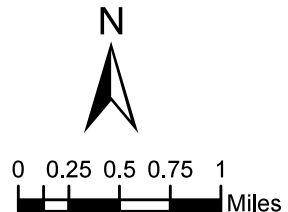
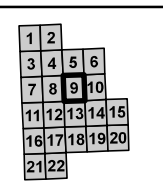



# Motor Vehicle Use Map 2024-2025

MAP INDEX 10

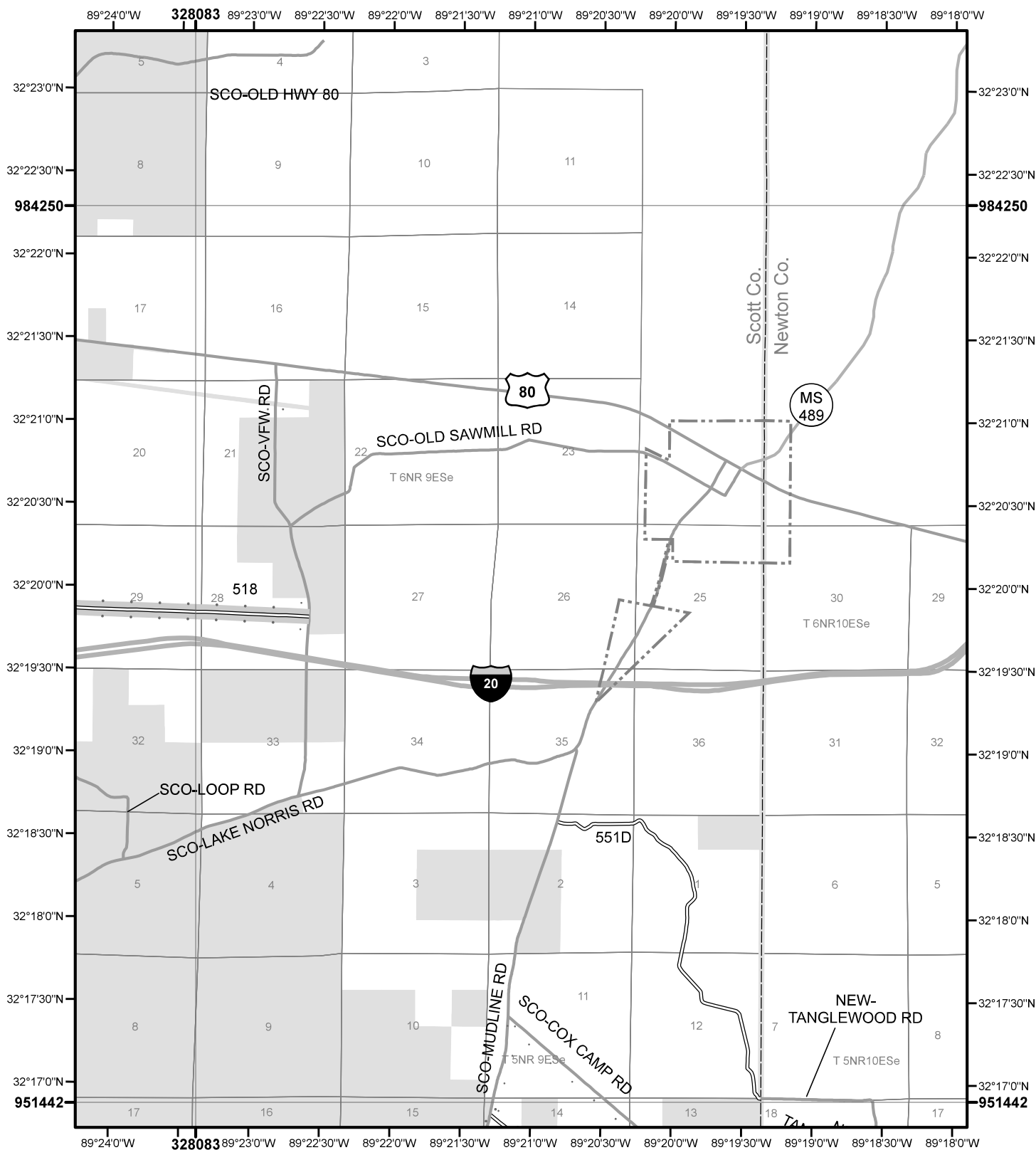

North American Datum of 1927 (NAD 27)  
State Plane, Mississippi East Zone, FIPS 2301 FS-873-807

• • Game Retrieval (See Table)  
(Used along with road and trail symbols listed above)

— Roads Open to Highway Legal Vehicles Only

— Special Vehicle Designation (See Table)

— Interstate

— Other Public Roads

Seasonal Designation (See Table)  
(Used along with road or trail listed above)

Forest or Unit Boundary

Non-National Forest System Lands within this National Forest

Lakes

## LEGEND

### Map Index

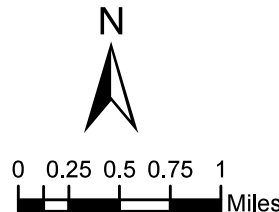
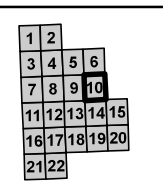



# Motor Vehicle Use Map 2024-2025

MAP INDEX 11

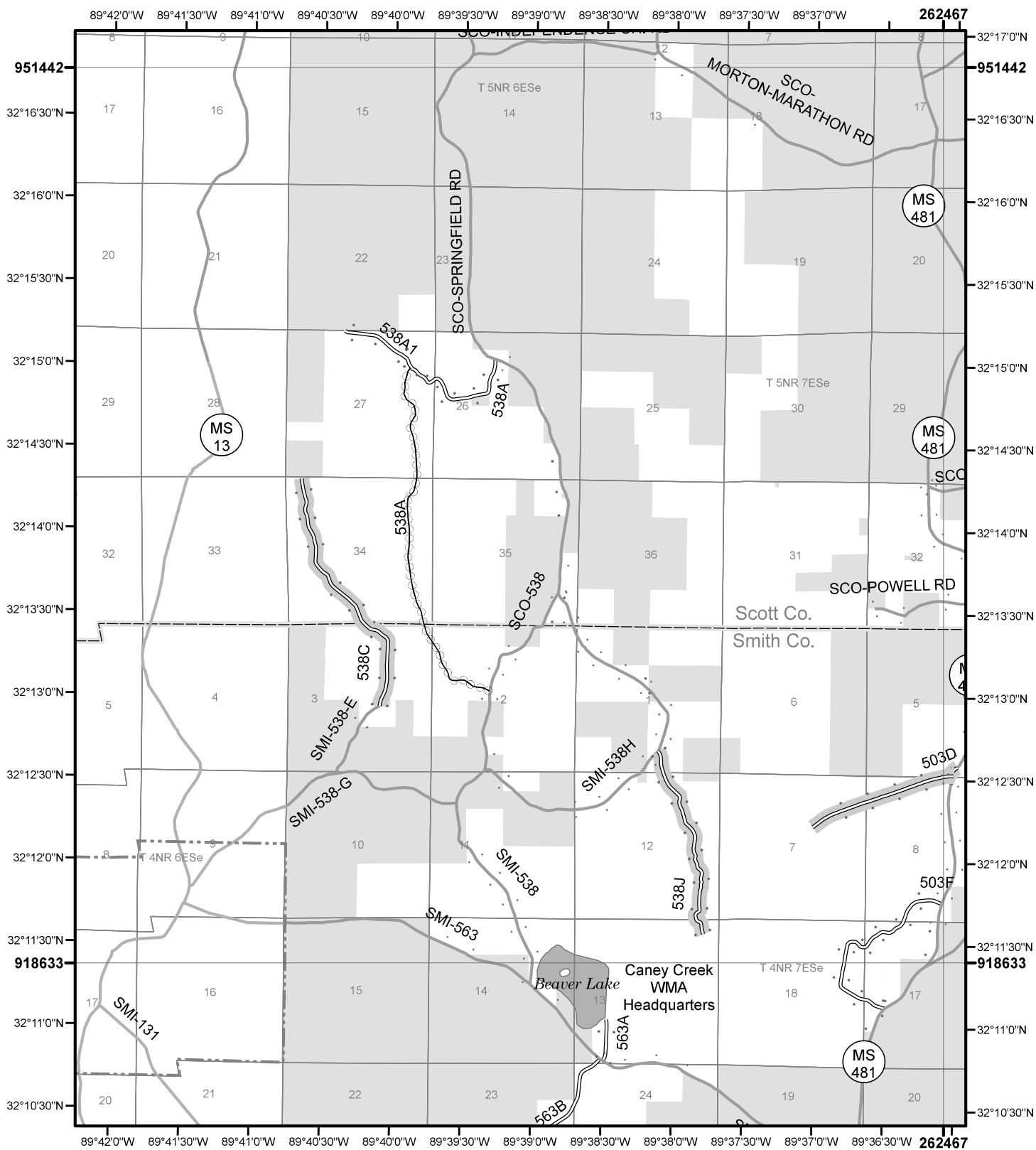

North American Datum of 1927 (NAD 27)  
State Plane, Mississippi East Zone, FIPS 2301 FS-873-807

- • Game Retrieval (See Table)  
(Used along with road and trail symbols listed above)
- Roads Open to Highway Legal Vehicles Only
- Special Vehicle Designation (See Table)
- Interstate
- Other Public Roads
- Seasonal Designation (See Table)  
(Used along with road or trail listed above)

- Forest or Unit Boundary
- Non-National Forest System Lands within this National Forest
- Lakes

### LEGEND

### Map Index

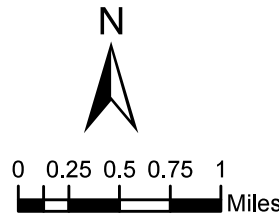
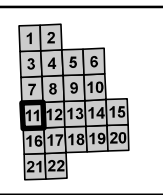



# Motor Vehicle Use Map 2024-2025

MAP INDEX 12

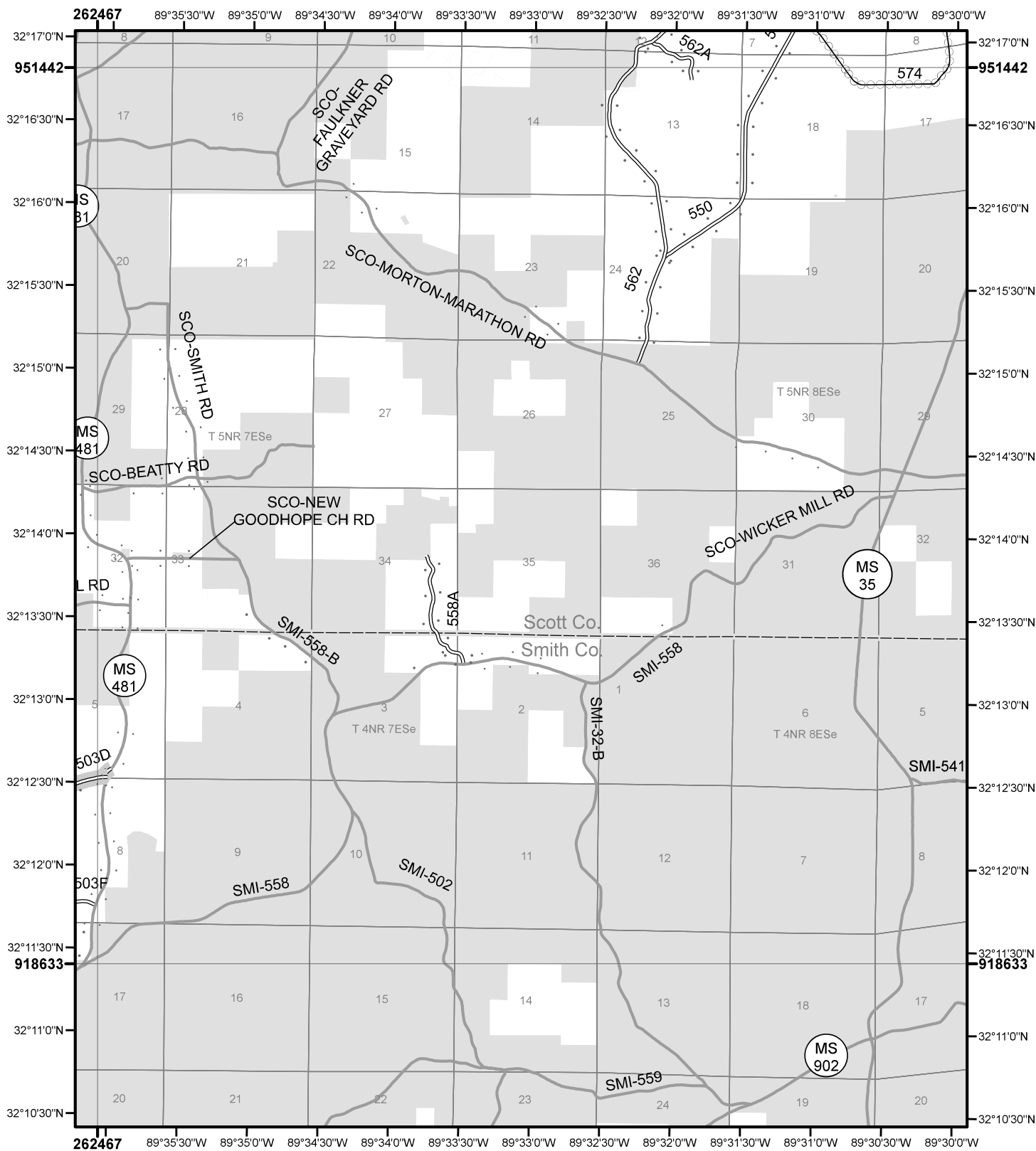

North American Datum of 1927 (NAD 27)  
State Plane, Mississippi East Zone, FIPS 2301 FS-873-807

- • Game Retrieval (See Table)  
(Used along with road and trail symbols listed above)
- Roads Open to Highway Legal Vehicles Only
- Special Vehicle Designation (See Table)
- Interstate
- Other Public Roads
- Seasonal Designation (See Table)  
(Used along with road or trail listed above)

- Forest or Unit Boundary
- Non-National Forest System Lands within this National Forest
- Lakes

**LEGEND**

## Map Index

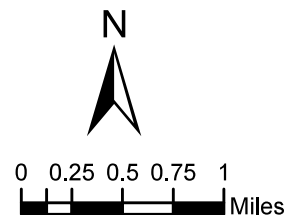
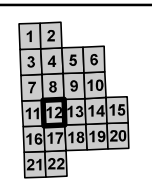



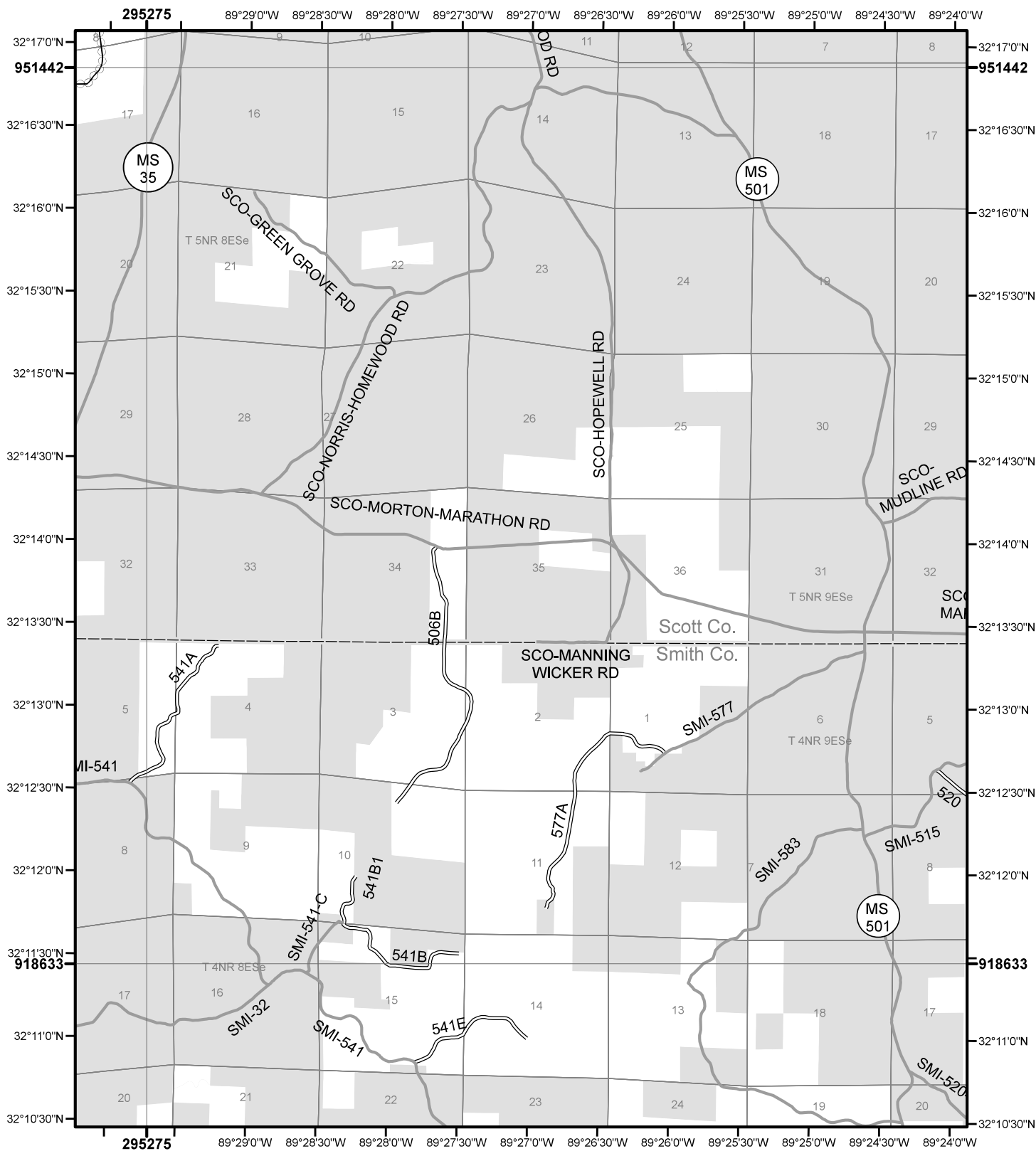

North American Datum of 1927 (NAD 27)  
State Plane, Mississippi East Zone, FIPS 2301

FS-873-807

- • Game Retrieval (See Table)  
(Used along with road and trail symbols listed above)
- Roads Open to Highway Legal Vehicles Only
- Special Vehicle Designation (See Table)
- Interstate
- Other Public Roads
- Seasonal Designation (See Table)  
(Used along with road or trail listed above)

- Forest or Unit Boundary
- Non-National Forest System Lands within this National Forest
- Lakes

## LEGEND

### Map Index

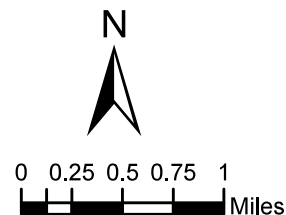
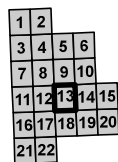



# Motor Vehicle Use Map 2024-2025

MAP INDEX 14

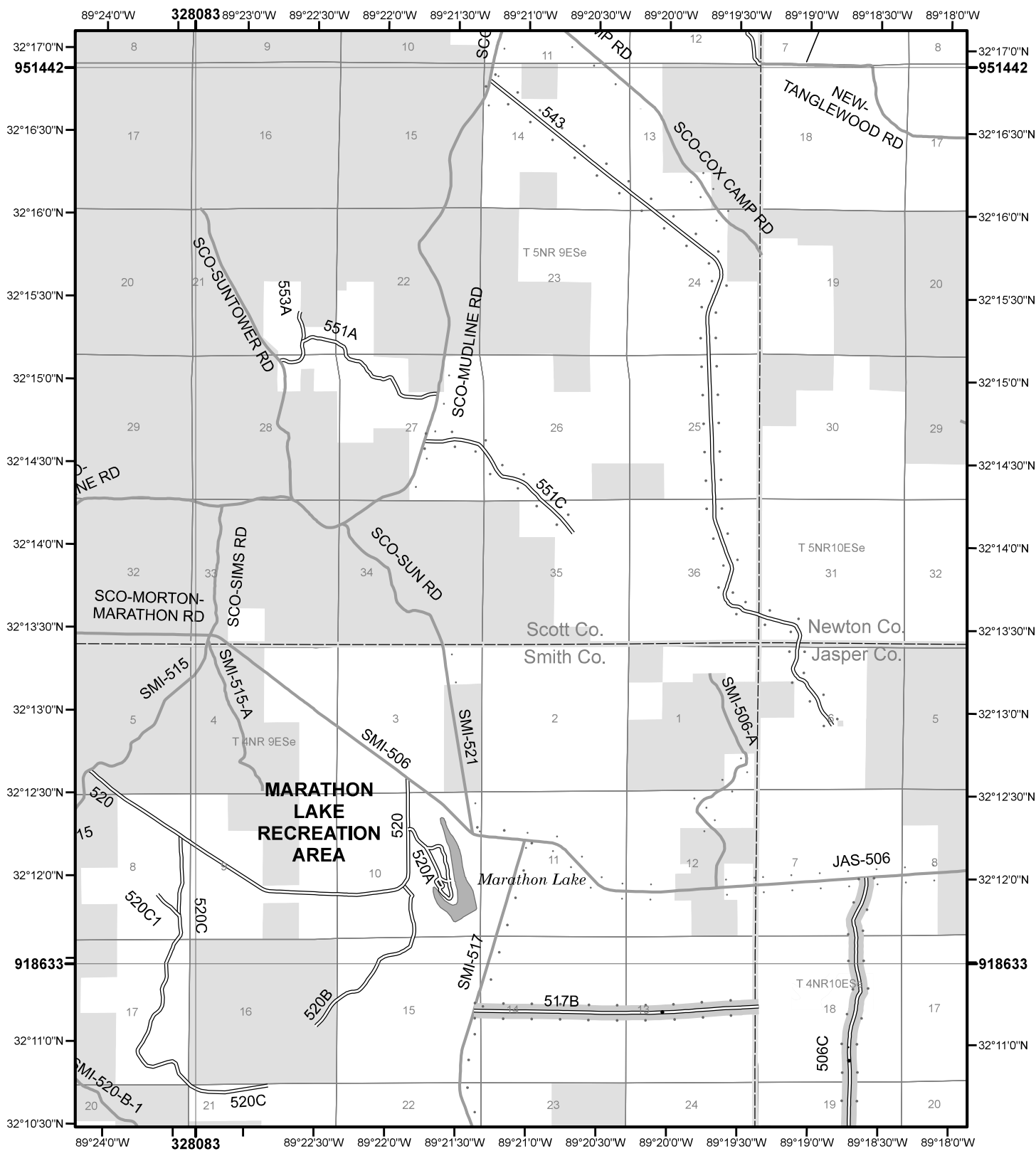

North American Datum of 1927 (NAD 27)  
State Plane, Mississippi East Zone, FIPS 2301 FS-873-807

- • Game Retrieval (See Table)  
(Used along with road and trail symbols listed above)
- Roads Open to Highway Legal Vehicles Only
- Special Vehicle Designation (See Table)
- Interstate
- Other Public Roads
- Seasonal Designation (See Table)  
(Used along with road or trail listed above)

- Forest or Unit Boundary
- Non-National Forest System Lands within this National Forest
- Lakes

**LEGEND**

### Map Index

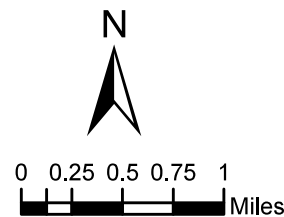
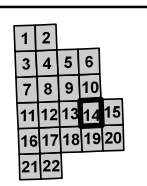



# Motor Vehicle Use Map 2024-2025

MAP INDEX 15

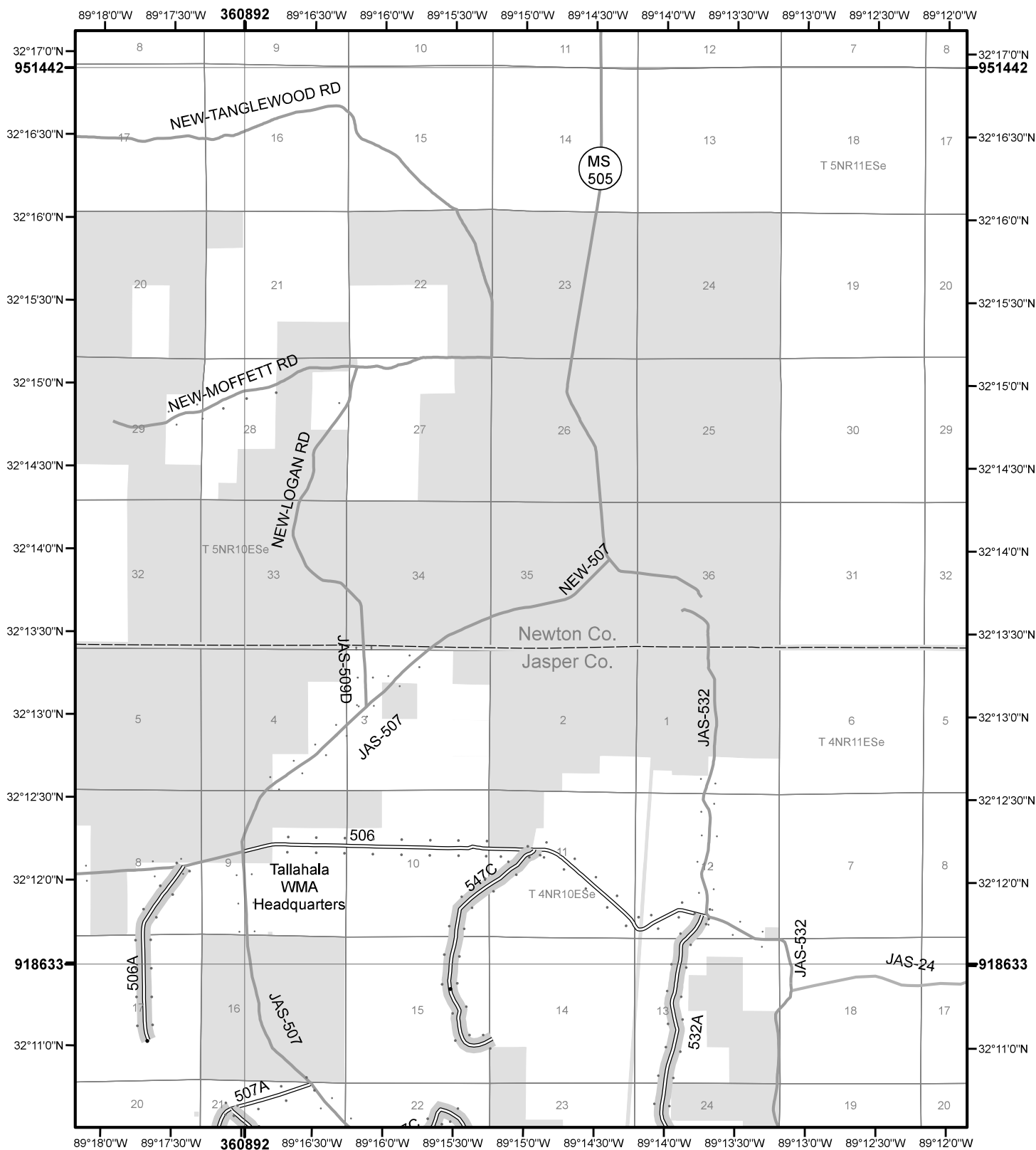

North American Datum of 1927 (NAD 27)  
State Plane, Mississippi East Zone, FIPS 2301

FS-873-807

- • Game Retrieval (See Table)  
(Used along with road and trail symbols listed above)
- Roads Open to Highway Legal Vehicles Only
- Special Vehicle Designation (See Table)
- Interstate
- Other Public Roads
- Seasonal Designation (See Table)  
(Used along with road or trail listed above)

- Forest or Unit Boundary
- Non-National Forest System Lands within this National Forest
- Lakes

**LEGEND**

## Map Index

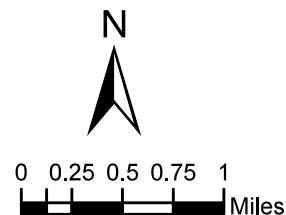
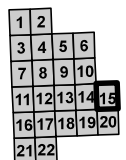







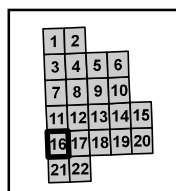



North American Datum of 1927 (NAD 27)  
State Plane, Mississippi East Zone, FIPS 2301 FS-873-807

## Map Index



## LEGEND

- |  |  |
|--|--|
| <ul style="list-style-type: none"> <li>• • Game Retrieval (See Table)</li> <li>• • {Used along with road and trail symbols listed above}</li> </ul>                  |  Forest or Unit Boundary                                      |
|  Roads Open to Highway Legal Vehicles Only  |  Non-National Forest System Lands within this National Forest |
|  Special Vehicle Designation (See Table)  |  Lakes  |
|  Interstate   |  |
|  Other Public Roads   |  |
|  Seasonal Designation (See Table)<br>{Used along with road or trail listed above} |  |
- LEGEND



# Motor Vehicle Use Map 2024-2025

MAP INDEX 17

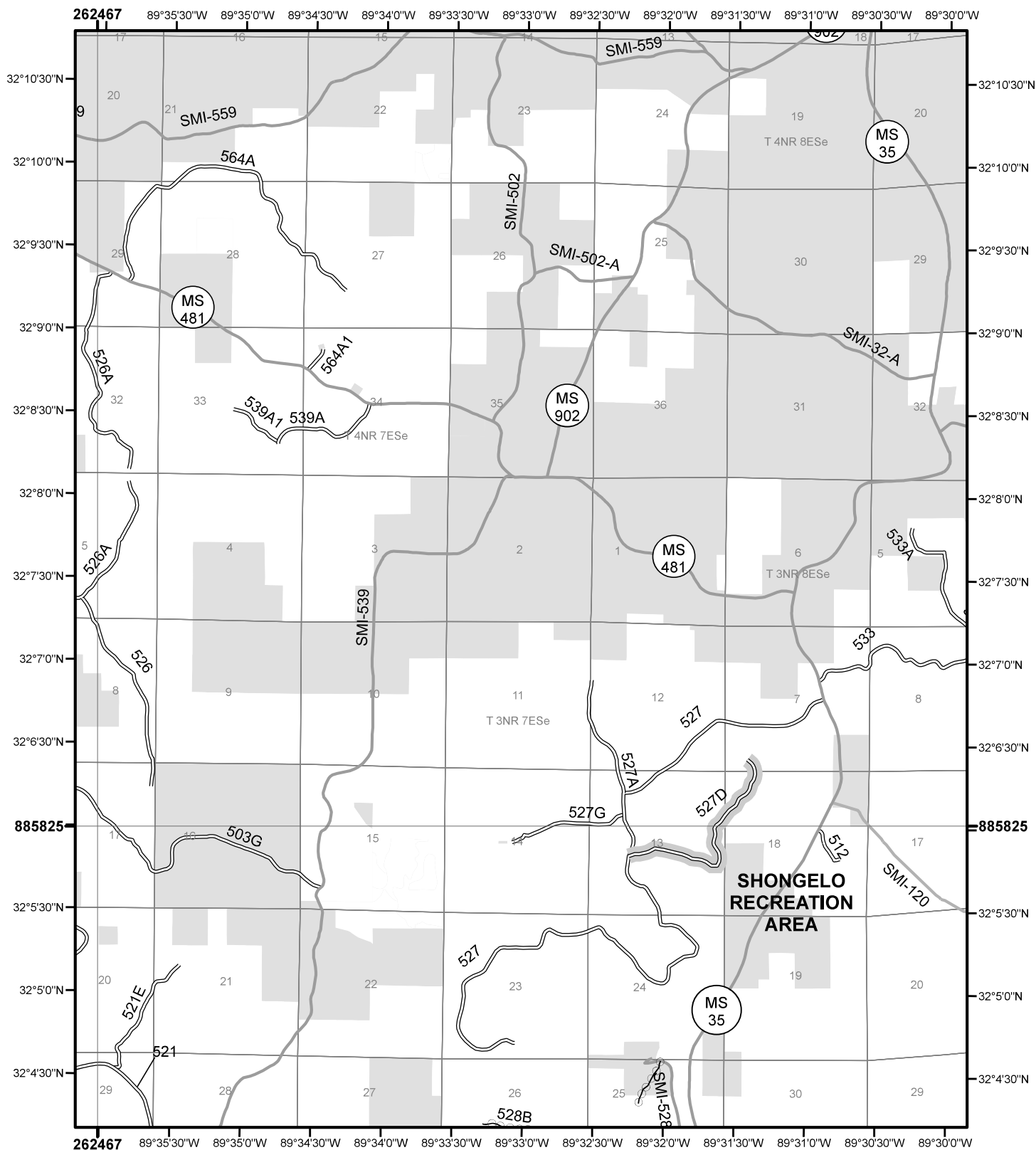

North American Datum of 1927 (NAD 27)  
State Plane, Mississippi East Zone, FIPS 2301

FS-873-807

- • Game Retrieval (See Table)  
(Used along with road and trail symbols listed above)
- Roads Open to Highway Legal Vehicles Only
- Special Vehicle Designation (See Table)
- Interstate
- Other Public Roads
- Seasonal Designation (See Table)  
(Used along with road or trail listed above)

- Forest or Unit Boundary
- Non-National Forest System Lands within this National Forest
- Lakes

**LEGEND**

## Map Index

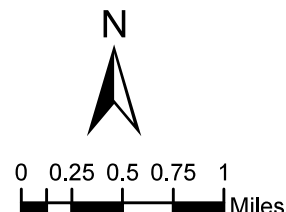
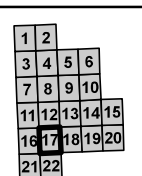

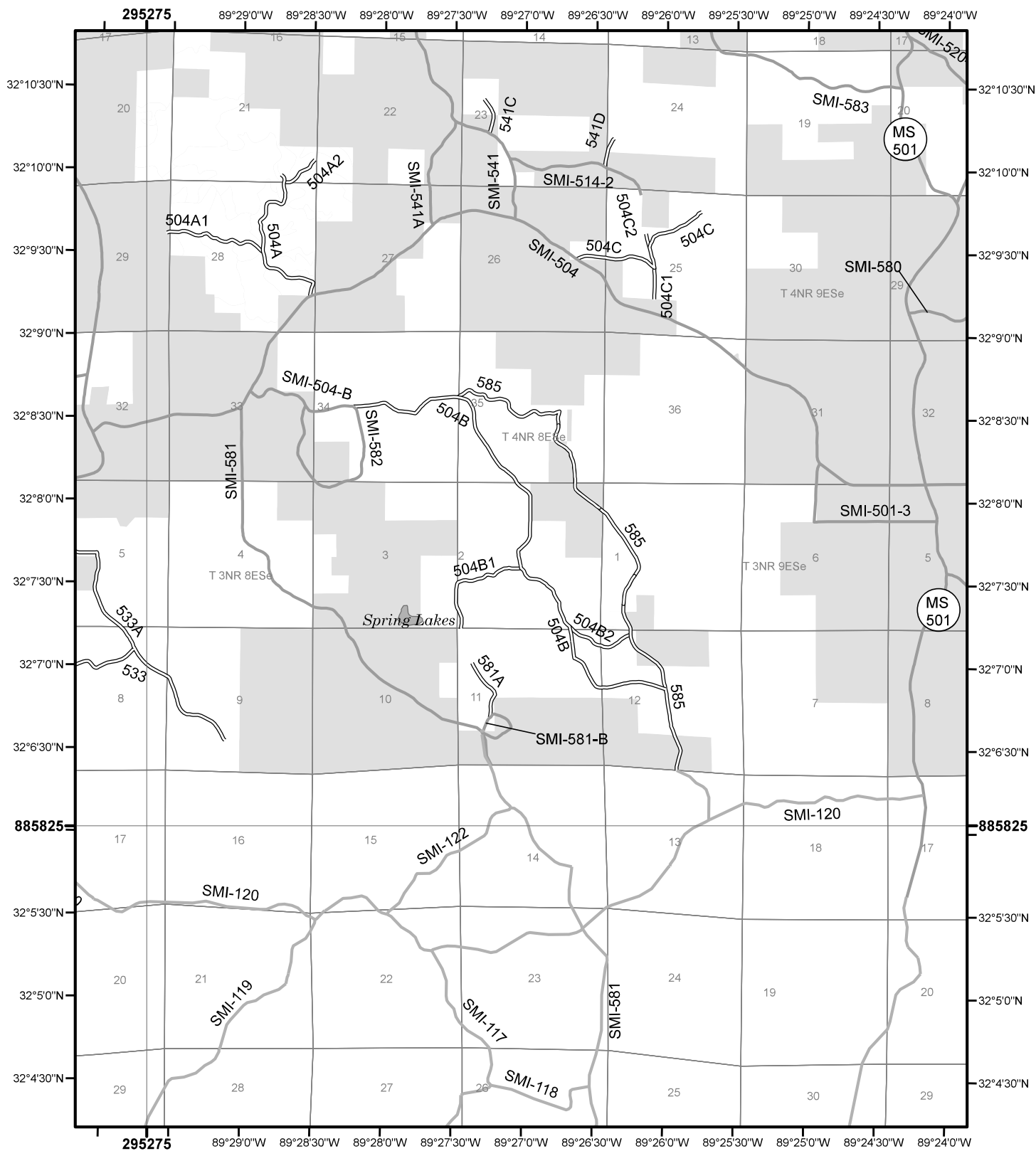

North American Datum of 1927 (NAD 27)  
State Plane, Mississippi East Zone, FIPS 2301

FS-873-807

- • Game Retrieval (See Table)  
(Used along with road and trail symbols listed above)
- Roads Open to Highway Legal Vehicles Only
- Special Vehicle Designation (See Table)
- Interstate
- Other Public Roads
- Seasonal Designation (See Table)  
(Used along with road or trail listed above)

- Forest or Unit Boundary
- Non-National Forest System Lands within this National Forest
- Lakes

LEGEND

### Map Index

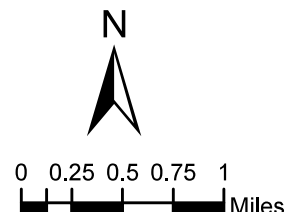
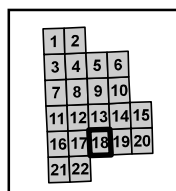



# Motor Vehicle Use Map 2024-2025

MAP INDEX 19

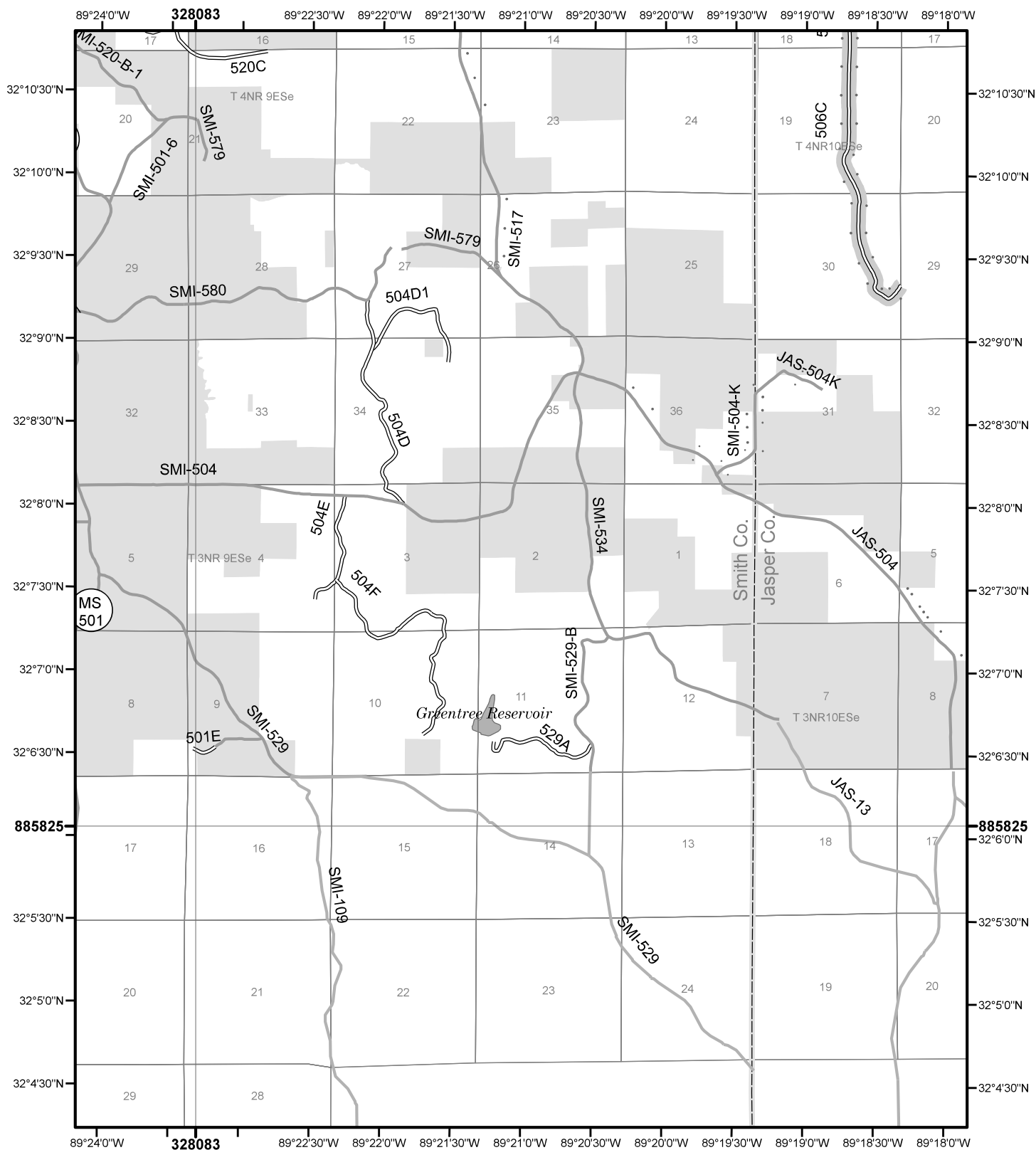

North American Datum of 1927 (NAD 27)  
State Plane, Mississippi East Zone, FIPS 2301

FS-873-807

- • Game Retrieval (See Table)  
(Used along with road and trail symbols listed above)
- Roads Open to Highway Legal Vehicles Only
- Special Vehicle Designation (See Table)
- Interstate
- Other Public Roads
- Seasonal Designation (See Table)  
(Used along with road or trail listed above)

Forest or Unit Boundary

Non-National Forest System Lands  
within this National Forest

Lakes

LEGEND

## Map Index

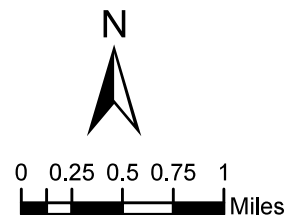
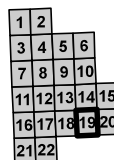

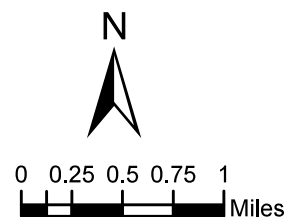





# Motor Vehicle Use Map 2024-2025

MAP INDEX 21

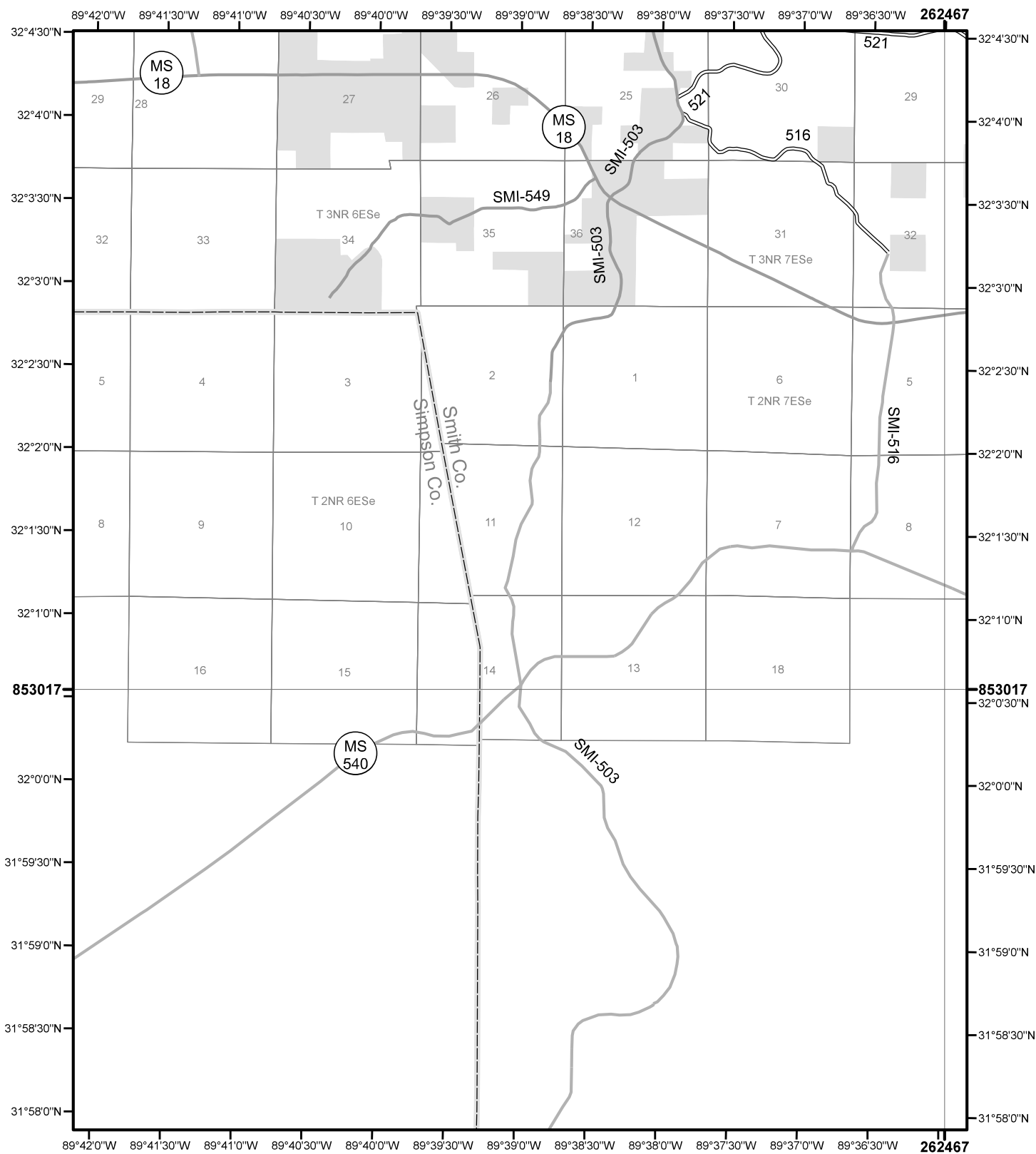

North American Datum of 1927 (NAD 27)  
State Plane, Mississippi East Zone, FIPS 2301 FS-873-807

- • Game Retrieval (See Table)  
(Used along with road and trail symbols listed above)
- Roads Open to Highway Legal Vehicles Only
- Special Vehicle Designation (See Table)
- Interstate
- Other Public Roads
- Seasonal Designation (See Table)  
(Used along with road or trail listed above)

- Forest or Unit Boundary
- Non-National Forest System Lands within this National Forest
- Lakes

**LEGEND**

## Map Index

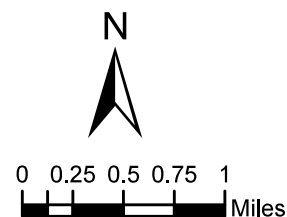
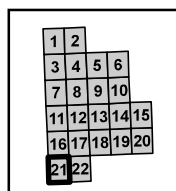



# Motor Vehicle Use Map 2024-2025

MAP INDEX 22

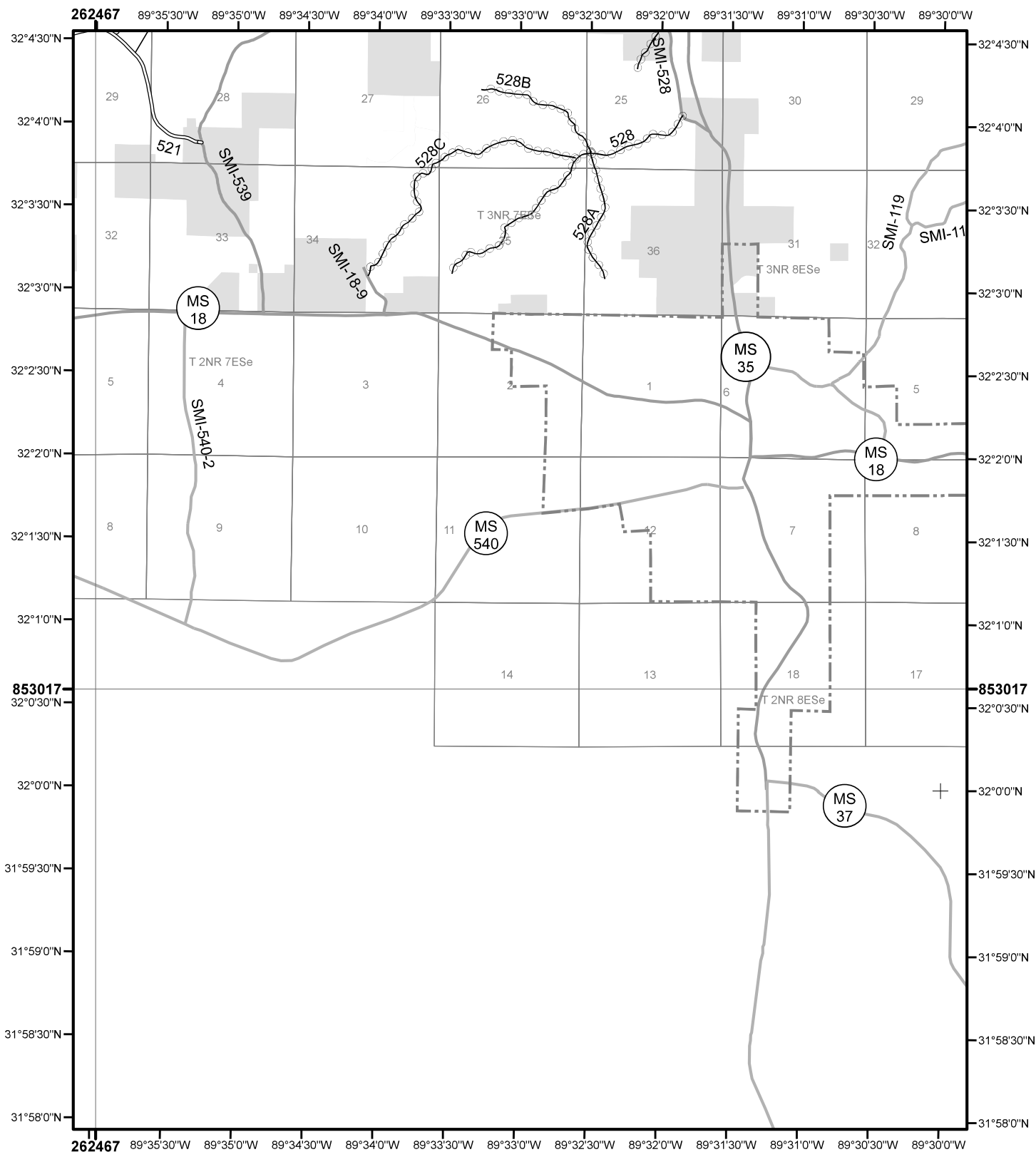

North American Datum of 1927 (NAD 27)  
State Plane, Mississippi East Zone, FIPS 2301 FS-873-807

- • Game Retrieval (See Table)  
(Used along with road and trail symbols listed above)
- Roads Open to Highway Legal Vehicles Only
- Special Vehicle Designation (See Table)
- Interstate
- Other Public Roads
- Seasonal Designation (See Table)  
(Used along with road or trail listed above)

- Forest or Unit Boundary
- Non-National Forest System Lands within this National Forest
- Lakes

LEGEND

### Map Index

