



PO Box 1499
Newport, WA 99156
(509) 447-3686

March 3, 2017

Gayne Sears
District Ranger
Newport-Sullivan Lake Ranger District
Colville National Forest
USDA-USFS
315 North Warren
Newport, WA 99156

RE: Limestone/Silver Vegetation Management Project

Dear Gayne;

Stimson Lumber Company (SLC) is in receipt of your February 15, 2017 solicitation letter regarding the Limestone/Silver Vegetation Management Project. As you know, SLC owns and actively manages a portion of the northeastern corner of your project area. SLC and USFS have long enjoyed a collaborative working relationship within the Metaline and Metaline Falls area, as evidenced by the adding the Colville-Stimson Agreement Area in 2001. To this end, Stimson would like to submit the following comments for your review and further incorporation into this important work.

Stimson owns two parcels in particular, one in Sec 16 T40N R43E W.M., (PeeWee Creek Area) and other in Sec 12 T40N R42E W.M., (Russian Ridge Area). In the past both parcels have been issued Road Use Permits (RUP) from the US Forest Service and Stimson would like to upgrade these past RUP's with permanent easements to both parcels and exchange access to Forest Service ownership in the near future. Section 16 T40N R43E parcel falls within the Colville-Stimson Agreement Cost Share area. Section 12 T40 R42E lies within no agreement area. I have attached a draft maps of past Road Use Permit routes (Proposed Easement routes) for your convenience.

Thank you very much for your time and consideration of our comments.

Sincerely,

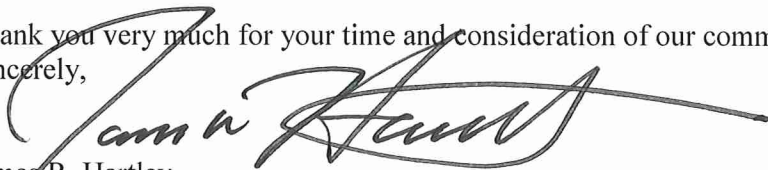

James R. Hartley
Colville Unit Manager



Stimson Proposed Easement Route to Sec 16 T40N R43E W.M.

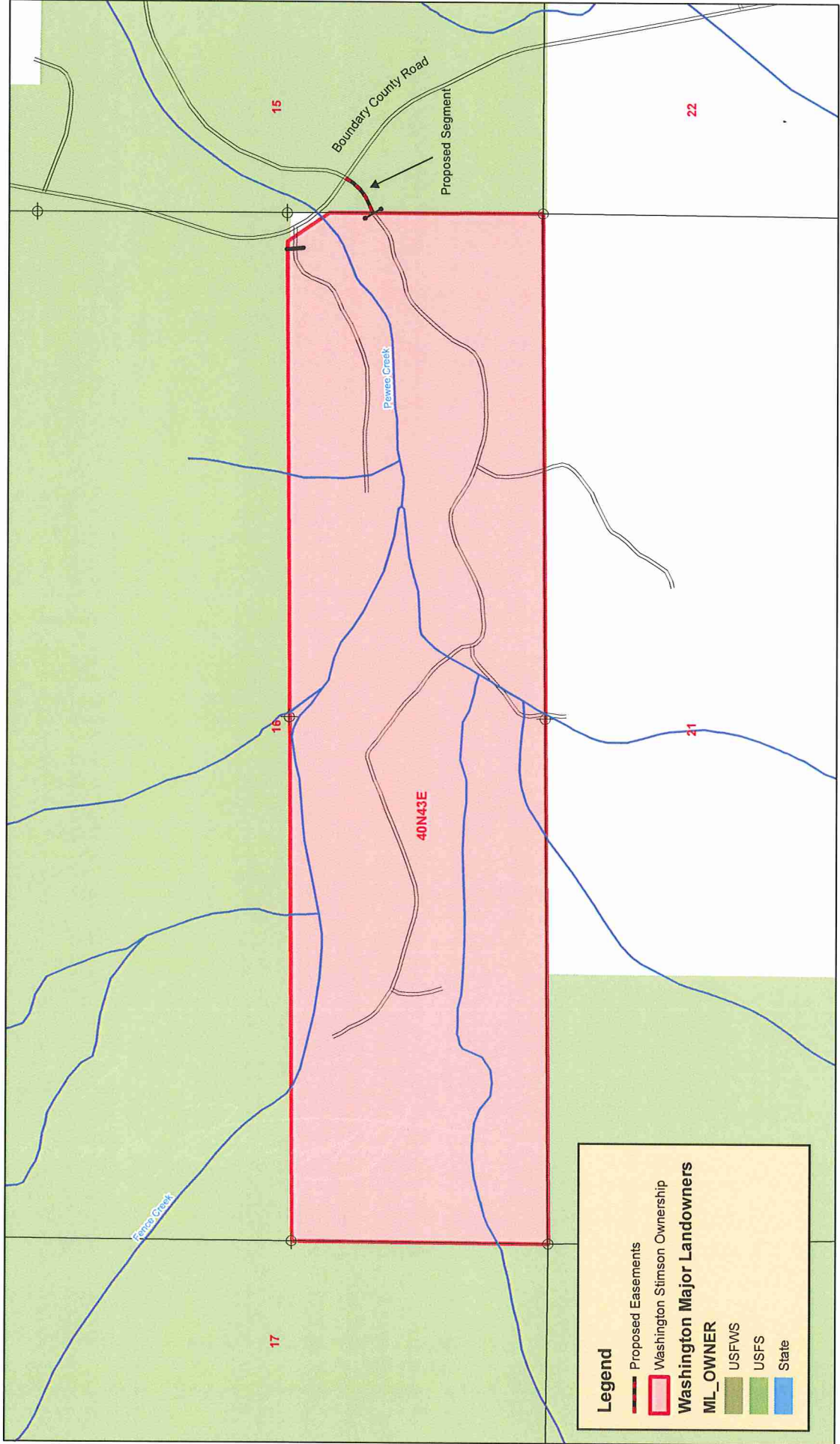



STIMSON LUMBER COMPANY

Stimson Proposed Easement Route to Sec 12 T40N R42E W.M.

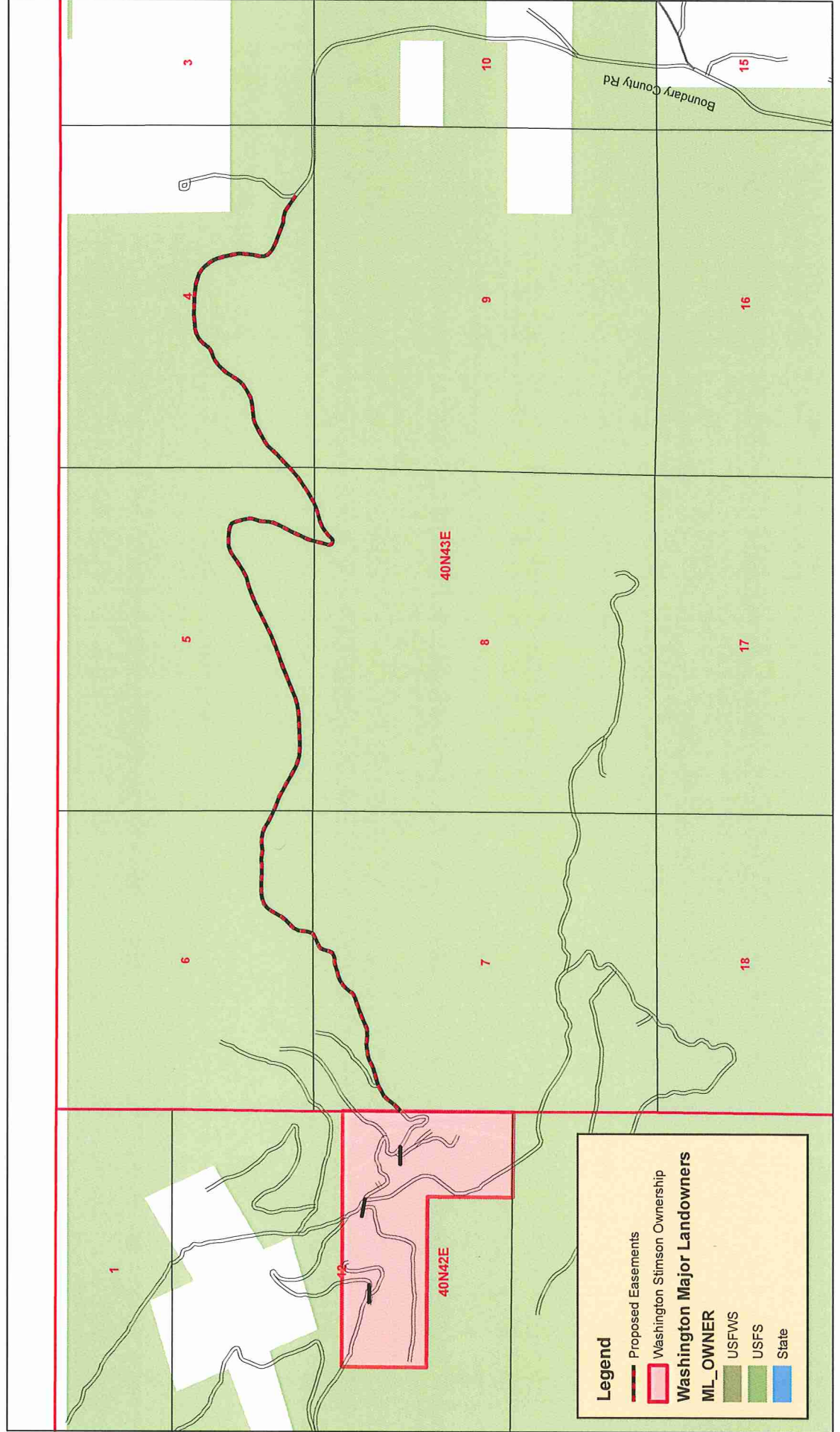

Legend

- Proposed Easements
- Washington Stimson Ownership
- Washington Major Landowners**
- ML_OWNER**
- USFWS
- USFS
- State