

**Nene SBA Timber Sale  
Logging Feasibility Report**

**Notes:** Due to the variability of the sale, there may be the need of intermediate support trees in units not so stated in this analysis. Rigging heights are based on a particular profile and will also differ from given heights throughout each unit. Unless otherwise stated skyline yarding direction will be uphill and Ground Based skidding directions will be downhill. All skidding and yarding operations will have constraints within stream corridors for units. See contract provision C6.42# for special yarding and skidding methods. All Ground based skid roads and landings must be approved prior to use. Skid roads will be placed 150' apart.

For Skyline operations, a carriage with skyline clamping capability will be required. Unless otherwise stated in the unit comments the Diamond D2000m, 42' boom, 7/8'' skyline, 5/8 inch mainline and ½ inch haul-back line will be used with an Acme-210 carriage for profile analysis. Skyline corridors for uphill yarding will be 150 feet apart at the farthest reach of the corridor. For downhill yarding the corridors' spacing can be adjusted to be closer than 150 feet with prior approval from the Contract Officer Rep.

In those areas which are recommended for ground base systems, and which have slopes in excess of 30%, shovel operations can be considered. Each situation must be looked at and approved by the TSO with the cooperation of the zone Geologist.

There may be small areas along and near landing sites that can be harvested in a manner not specified in the logging plan. With prior approval from the TSO these areas may be harvested using alternate methods of operations.

Guyline anchors, intermediate support trees and tailspar trees for all units are of adequate size for operations unless otherwise stated under unit comments. Intermediate support tree and tail spar heights are determined in accordance to OSHA standards and guidelines.

Nene SBA Timber Sale Feasibility Report

Unit: 140	Temporary Spurs (Ft.)
Stand: 7002249	New: 300
Elevation: 1960-2320'	Existing: 0
Age: 42	Total: 300
Acres: 4	
LMA: 11C, 17	Number of Landings
DXD': 18	GB: 2
DTRs: 0	SkyL: 0
	HeC: 0
Logging Systems Acres	
GB: 4	Gaps Ac: 0
SkyL: 0	Skip Ac: 1
HeC: 0	

Stand Remarks:

All of unit 140 can be ground base skidded favorably to the existing 2600254-forest road. There is a proposed temporary spur road that can be implemented to facilitate shorter skidding distances. The new proposed temp spur is approximately 300 feet in length. The longest skidding distance is approximately 425 feet.

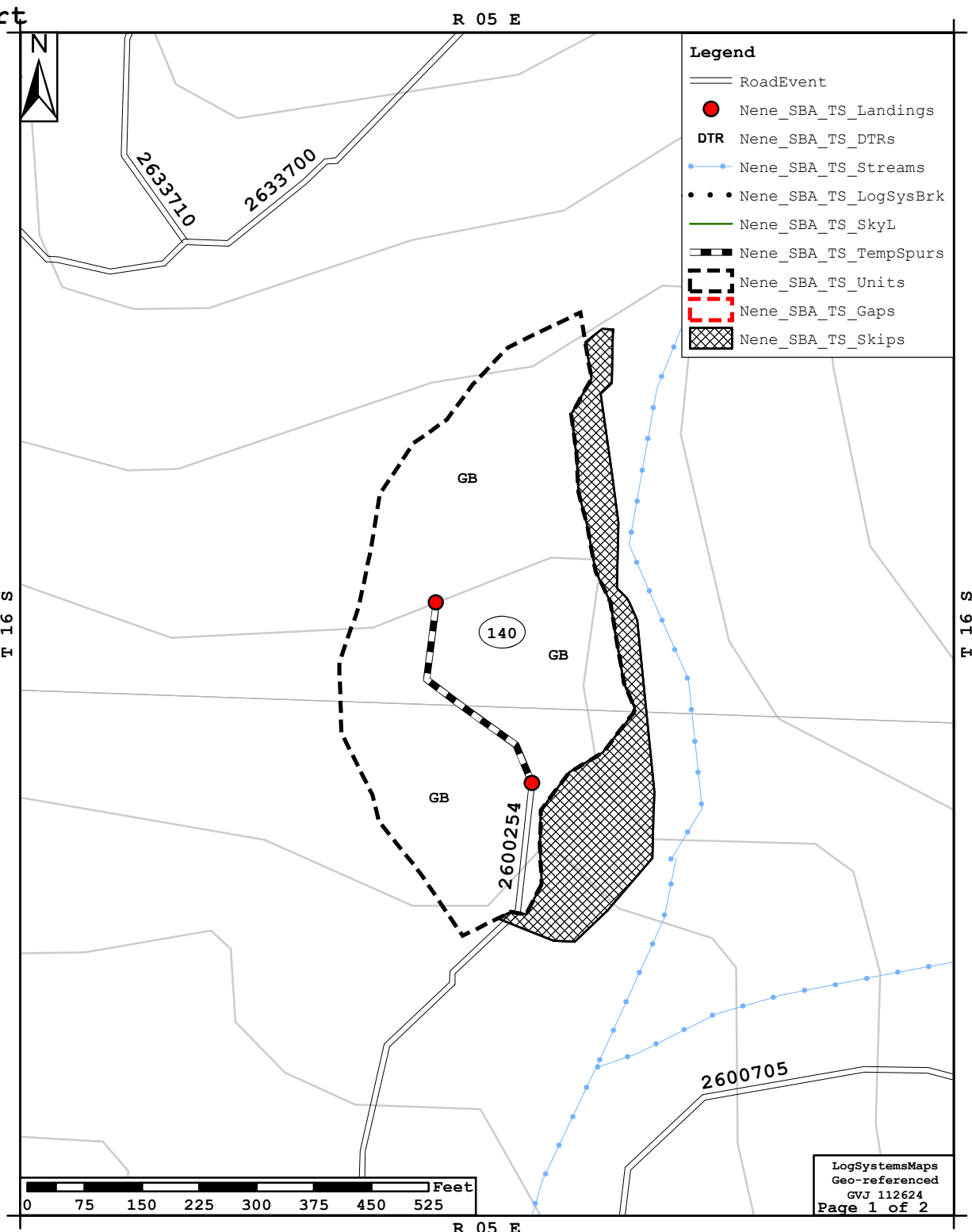
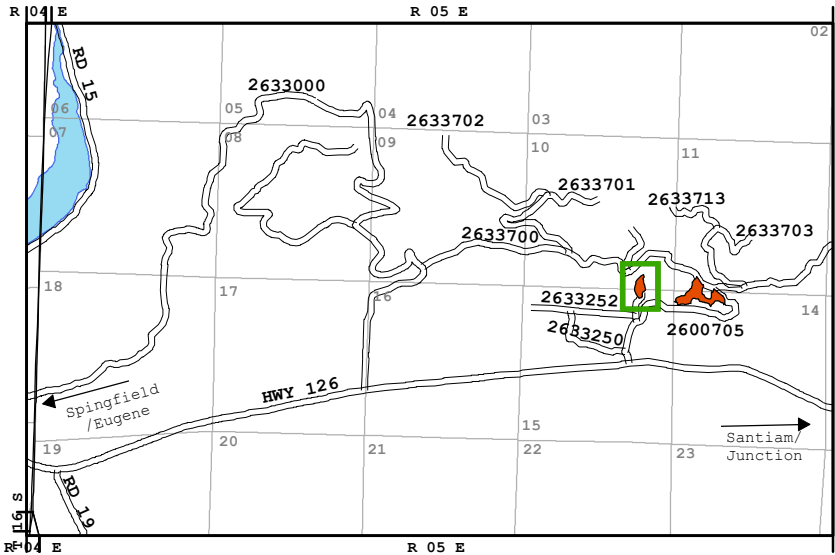

Nene SBA Timber Sale Feasibility Report

Unit:	190	Temporary Spurs (Ft.)	
Stand:	7002225	New:	0
Elevation:	1720-2160'	Existing:	700
Age:	42	Total:	700
Acres:	17		
LMA:	11C, 17	Number of Landings	
DXD':	18	GB:	2
DTRs:	5	SkyL:	5
		HeC:	0
Logging Systems Acres			
GB:	8	Gaps Ac:	3
SkyL:	9	Skip Ac:	9
HeC:	0		

Stand Remarks:

Unit 190 can be looged utilizing both ground base and skyline yarding equipment. The are some skyline landings off the 2633700-forest road that will facilitate skyline yarding operations. There is a proposed temporary spur road located off 2633700-forest road, that will provide access to log what the skyline yarder could not reach from above. This area can be logged with groundbase eqiement. There are some slopes above 30% for short pitches that can be logged with a shovel. The proposed temporary spur is located is located on existing tread and is approximately 700 feet. Unit 191 can be skyline yarded uphill to the 2633705-forest road. The longest yarding distance is approximately 700 feet. The average yarding distance is 420 feet. The southwest corner of the unit has slopes under 25% and can be ground base skidded favorably to the existing 2600259-forest road. The longest skidding distance is approximately 200 feet. The average skidding distance is approximately 120 feet.

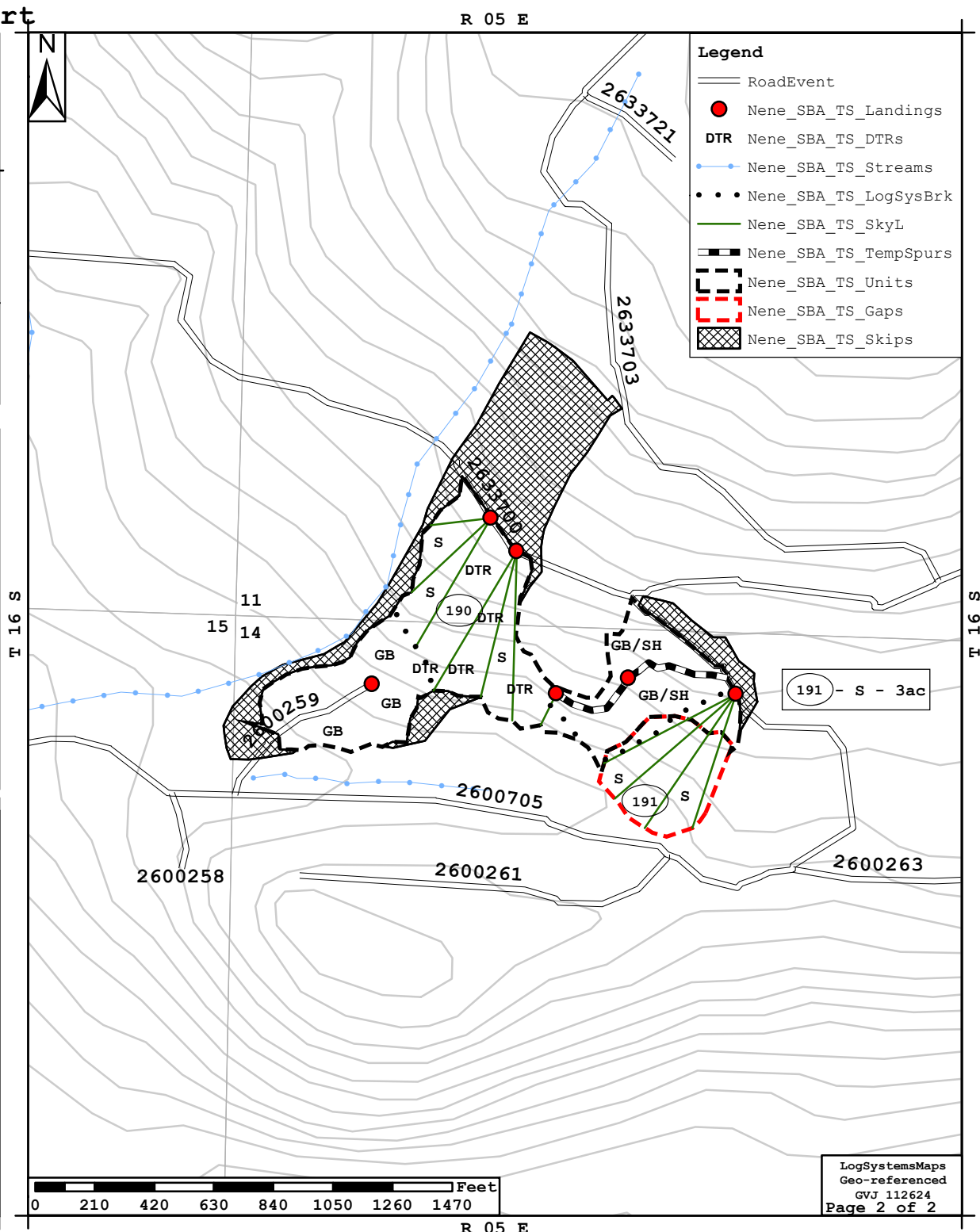
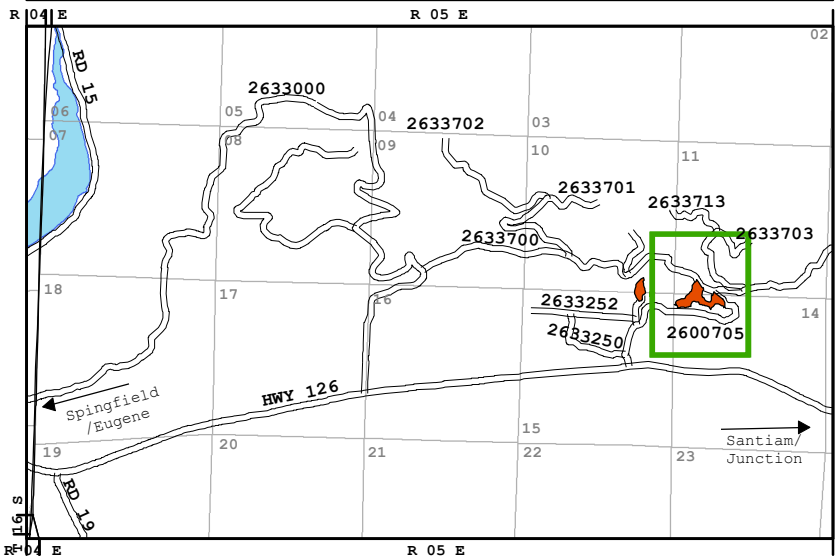

- Legend
- RoadEvent
  - Nene\_SBA\_TS\_Landings
  - DTR Nene\_SBA\_TS\_DTRs
  - Nene\_SBA\_TS\_Streams
  - Nene\_SBA\_TS\_LogSysBrk
  - Nene\_SBA\_TS\_SkyL
  - Nene\_SBA\_TS\_TempSpurs
  - Nene\_SBA\_TS\_Units
  - Nene\_SBA\_TS\_Gaps
  - Nene\_SBA\_TS\_Skips

